



Manufacturer and Supplier of
Restaurant Equipment
 and **Display Cases**
 for the Food Service Industry



MODEL: RW-73-SC

PRODUCT FEATURES

Self-Contained
 Stainless Steel front
 White vinyl coated aluminum interior
 (2) Glass Sliding doors
 Florescent interior lighting
 Holds 33°-41°F temperatures
 Adjustable vinyl coated wire shelves
 Compressor can be serviced easily
 Environmentally friendly 134A refrigerant
 1/2 HP, 115V, 15.2 Amps

Casters	5" Casters Optional
Warranty	1 yr Parts & Compressor
Front Door	Glass
Front Motor Cover	Anodized Aluminum
Interior Walls	White Aluminum
Outside Back	Galvanized

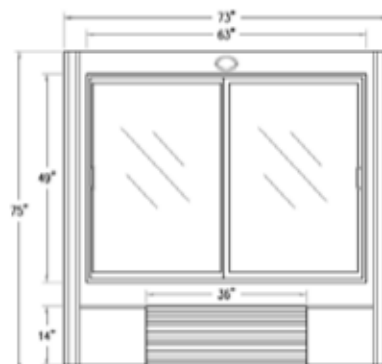
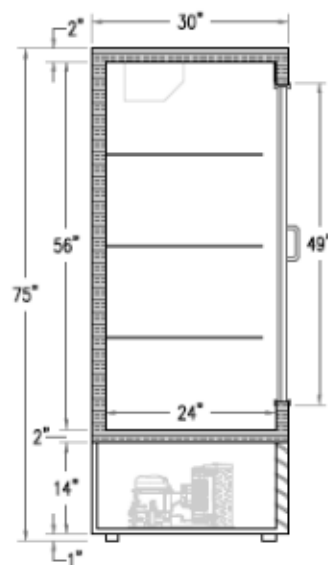

Product Specifications

Dimensions	Doors	Shelves	Cooling Cycle	Refrigerant	HP	Power	Ampr.	BTU	Freon (oz)
73" X 30" X 75"	2	6	33-41	134a	1/2	115/60/1	15.5	1700	15

Additional Models

Model #	Doors	Shelves	Cooling Cycle	Refrigerant	HP	Power	Ampr.	BTU	Freon (oz)
RW-38-SC	2	3	33-41	134a	1/3	115/60/1	12.5	1200	11.5
RW-48-SC	2	6	33-41	134a	1/3	115/60/1	13.5	1400	11.5
RW-54-SC	2	6	33-41	134a	1/3	115/60/1	13.5	1400	11.5
RW-96-SC	4	12	33-41	134a	1/2	115/60/1	18.5	2300	15

* Model number designates product length. Due to product improvement, we reserve the right to change specifications without notice.

Kitchenall 917-525-2066 www.kitchenall.com support@kitchenall.com