

Model:  
**EGDM-29B**

## Swinging Glass Door / Reach-In

 Cooler

 White  
 Black

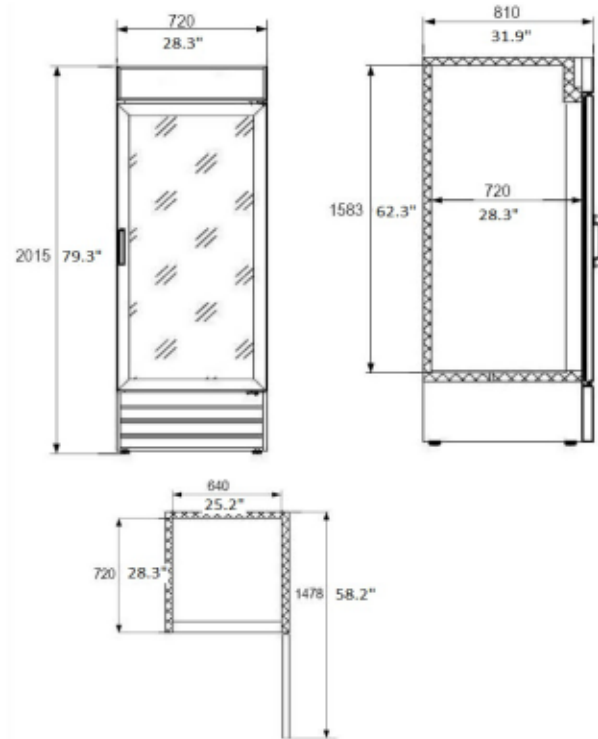

5-15P



Doors	Shelves	Refrigerant	HP	Power	Amps.	Cu.ft.	Weight(lbs.)
1	4	R290	1/4+	115/60/1	6	14	280

## FEATURES

### Cabinet Construction

- ✓ Exterior - Coated steel.
- ✓ Interior - Attractive, aluminum liner with stainless steel floor.

**Rounded corner** design inside of the cabinet makes it easy to clean it.

### Standard door features:

- ✓ Double pane thermal insulated glass door assembly with extruded plastic frames.

### Refrigeration system:

- ✓ Holds 33°F to 41°F (0.5°C to 5°C) ideal for fresh food products.

### Electronic control system:

- ✓ Adjustable temperature set point and defrost frequency.
- ✓ Error codes to diagnose service issues.

**Shelves:** Adjustable, heavy duty PVC coated shelves.

**LED light inside of the cabinet.**

**Standard heavy-duty casters** make it easy to move and clean underneath.

"No Stoop" lower shelf.

Storage on top of cabinet.

Easily accessible condenser coil for cleaning, and easy service access.

Simple installation with no plumbing required.