

Model:  
BBCI-4824G

## 24" Wide Back Bar

 Cooler

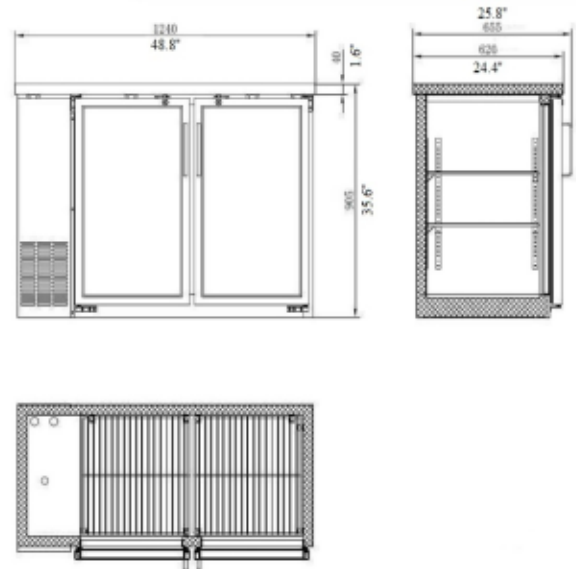

5-15P



Doors	Shelves	Refrigerant	HP	Power	Amps.	Cu.ft.	Weight(lbs.)
2	4	R290	1/3	115/60/1	6.4	11.8	200

## FEATURES

### Cabinet Construction standard:

- ✓ Exterior includes attractive, wear resistant vinyl on steel in black finish.
- ✓ Internal standard construction utilizes stainless steel walls, floor and ceiling.

### Refrigeration system:

- ✓ Uses R290 which is CFC and HCFC-free to protect the environment.
- ✓ Holds 33°F to 38°F (0.5°C to 3.3°C) for the best in food preservation.

### Electronic control system:

- ✓ Plug-in directly 115/60/1, 15amp.

**Sanitation:** SNF-7 approved for packaged and bottled product.

**LED light:** inside in cabinet.

Easily accessible condenser coil for cleaning, and easy service access.

Simple installation with no plumbing required.

Designed to accommodate a variety of beer kegs.