



Manufacturer and Supplier of  
**Restaurant Equipment**  
 and **Display Cases**  
 for the Food Service Industry



# MODEL: ADM-5

## PRODUCT FEATURES

- Mirror finish exterior
- White vinyl coated aluminum interior
- Remote (more interior space)
- Five REVERSIBLE ANTHONY swing glass doors
- Florescent interior lighting
- Holds 33°-41°F temperatures
- 4 adjustable vinyl coated wire shelves per door
- Control panel on top to control lights, fans, and heater
- Chrome doors available
- Gold doors available

Casters	NA
Warranty	1 yr Parts
Front Door	Glass
Front Motor Cover	NA
Interior Walls	White Aluminum
Outside Back	Galvanized

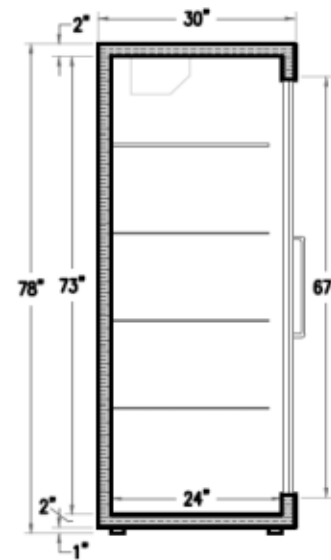
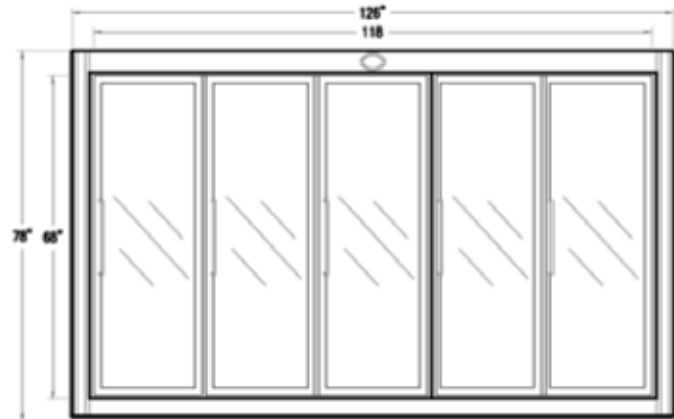

### Product Specifications

Dimensions	Doors	Shelves	Cooling Cycle	Refrigerant	HP*	Power	Ampr.	BTU	Freon (oz)
126" X 30" X 78"	5	20	33-41	NA	1	115/60/1	10	5500	NA

### Additional Models

\* Recommended Condensing Unit

Model #	Doors	Shelves	Cooling Cycle	Dimensions	HP*	Power	Ampr.	BTU	Freon (oz)
AMD-2	2	8	33-41	55x30x78	1/2	115/60/1	4.8	1700	NA
AMD-3	3	12	33-41	78x30x78	3/4	115/60/1	6.8	1200	NA
AMD-4	4	16	33-41	103x30x78	3/4	115/60/1	8	4300	NA
AMD-6	6	24	33-41	150x30x78	1 1/2	115/60/1	14	6000	NA

\* Model number designates number of doors. Due to product improvement, we reserve the right to change specifications without notice.