

<b>Project:</b>	<b>Quantity:</b>
<b>Model #:</b>	<b>Approval:</b>

*For Commercial Use Only*

**30" x 48" Stainless Steel Enclosed Base Work Table with Sliding Doors and Adjustable Shelf**

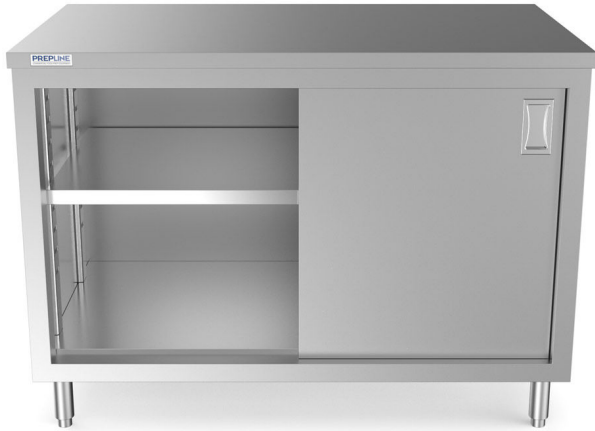

**STANDARD FEATURES**

- Fully Enclosed Base Table
- 30"D x 48"L Worktop Area
- Stainless Steel Construction
- Sliding Doors
- Adjustable and Removable Shelf
- Adjustable S/S Bullet Feet
- **Optional 5" Height Backsplash**

Bring versatility, durability and convenience to your food prep routines with this Prepline 30"D x 48"L stainless steel enclosed base work tables.

**TECHNICAL DATA**

Model	Length	Width	Work Surface Height	Backsplash Height	Stainless Steel Type	Packaging Dimensions
PC-3048	48"	30"	36"	/	430	31" x 49" x 8"
PCB-3048	48"	30"	36"	5"	430	33" x 49" x 8"



**FRONT**

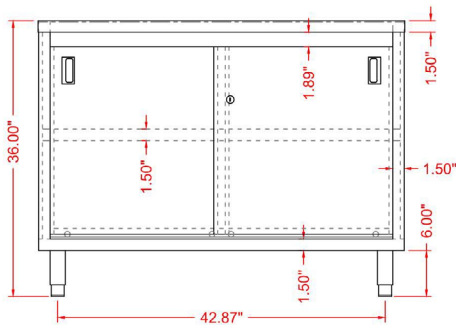

**SIDE**

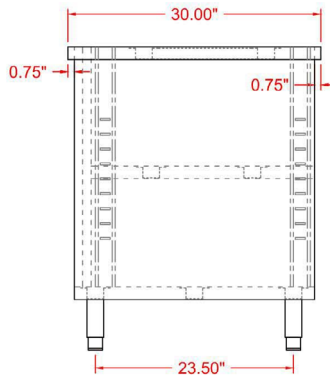

**TOP**

