

GENERAL SPECIFICATIONS

► FINISH:

Walls and ceilings: Standard 26 Gauge Stucco Embossed Galvalume Finish with a weather Protective aluminum and zinc alloy, 26 Gauge Stucco Embossed White Galvalume or 26 Gauge Stainless Steel 2B Finish with PVC.

► FLOORS:

Heavy gauge smooth aluminum. Optional Stainless Steel & Marine Plywood Reinforcement.

► INSULATION:

4" TRP for walk-in coolers and freezers.
EISA of 2007 & US D.O.E Certified Compliant

COOLERS:

4" Thermal Resistant Panel*
ASTM Test C-518
Flame spread and smoke development 5/190 ASTM Test E84

FREEZERS:

4" Thermal Resistant Panel*
ASTM Test C-518
Flame spread and smoke development 15/250 ASTM Test E84

► JOINT:

Panels have factory installed, NSF approved gasket, which insures a proper seal and better appearance. Standard gaskets are 1/8" closed cell neoprene.

► DOORS:

Standard door size is 34" X 76". Includes: Self closing hinges, automatic door closer, keyed entry latch with interior safety release, vapor proof light fixture, pilot light switch and dial thermometer. Freezer doors include anti condensate heater wire and pressure relief vent.

► CONSTRUCTION:

Panel facing shall be laminated to rigid insulation with urethane based adhesive under pressure to insure a strong and permanent bond. Panels are of 100% insulation (non wood construction) and all panel edges are tongue and groove. Panel connectors are factory installed rotary cam type speed locks. Floor panels are designed to sustain a load of 500 lbs. per square foot. Where floor panels are not required, 1" x 1" aluminum angle or NSF plastic screed will be furnished to insure a proper seal. Optional reinforcements can be added for heavier loads.

► INSTALLATION:

To help reduce installation time, all panels are marked to correspond with the installation drawing supplied by the factory. Also provided, one allen wrench along with miscellaneous installation materials.

PANEL CONSTRUCTION

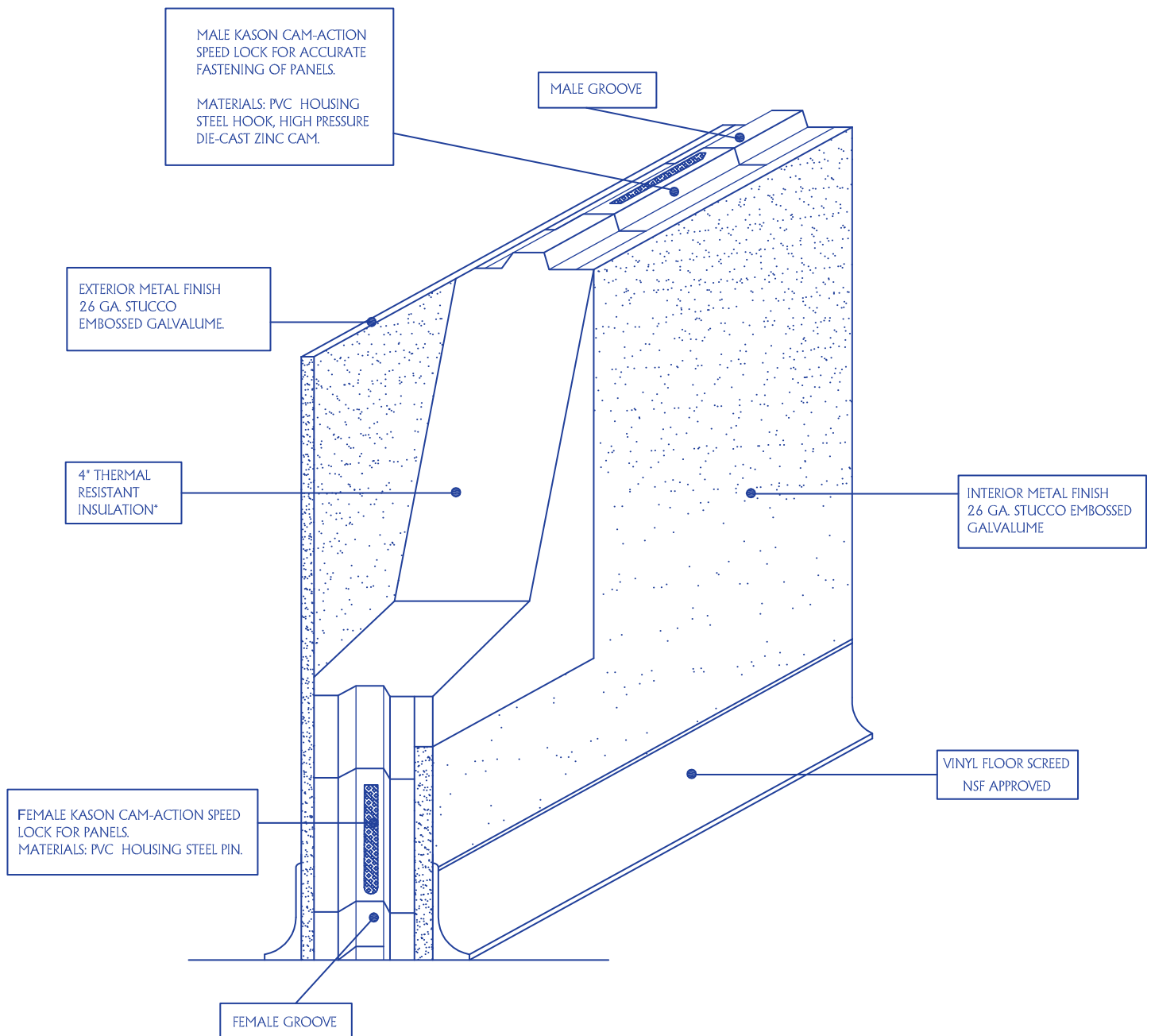

- ▶ SINGLE SPAN PANELS CAN BE PRODUCED UP TO 24'FT IN LENGTH WITHOUT STRUCTURAL SUPPORT.
- ▶ CEILING SPANS TO 16'FT ON INDOOR INSTALLATION WITHOUT STRUCTURAL SUPPORT.
- ▶ OUTDOOR APPLICATIONS AVAILABLE
- ▶ CUSTOM BUILT SIZES AND ANGLE WALK-INS WITHOUT THE CUSTOM BUILT PRICES.