

# Modular Ice Maker KCM-670-AH



## Durable Design

- Created to endure the every day use of your commercial environment
- Simple plug-in installation
- High quality construction to ensure reliability, longevity and product durability

## Energy Efficiency

- Improved evaporator freezing surface allowing for increased production and lower operating costs

## Superior Quality

- Designed for efficiency and dependability
- Stainless steel exterior for superior resilience to rust
- Simple to use
- Control board with on-board self-diagnostics
- Internal safety switches monitor and protect the refrigeration system
- Up to 666 lbs of ice production per 24 hrs



Bin KB-350 shown above is not included - sold separately

## Half Cube Dimensions

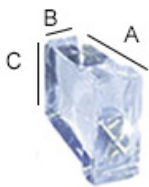

A: 1.10"  
B: 0.30"  
C: 0.80"



Intertek Intertek



5659 Royalmount Ave.  
Montreal, QC, Canada H4P 2P9  
Telephone: 514.737.9701 / Toll Free: 888.275.4538  
Fax: 514.342.3854 / Toll Free: 877.453.8832  
sales@mvpgroupcorp.com / mvpgroupcorp.com

Project Name:	
Location:	
Item:	Qty:
Model:	

12000 Biscayne Blvd., Suite # 108  
Miami, FL, United States 33181  
Telephone: 786.600.4687 / Toll Free: 844.218.8477  
Fax: 786.661.4100



A : Water Inlet (3/8" FPT)  
 B : Drain (3/4" FPT)  
 C : Power Cord

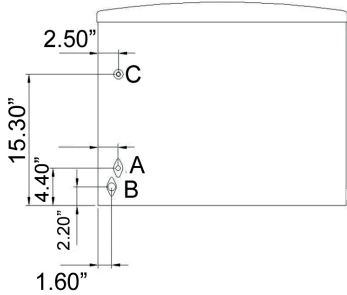
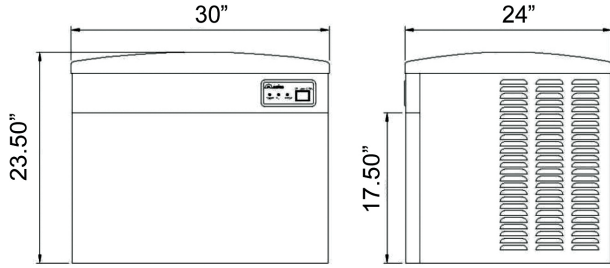

**Dimensions with KB-350 Bin**  
 \*unit sold separately

Height: 65.60" (includes 4" feet)  
 Width: 30"  
 Depth: 34.30"

Bin storage: 354 lbs / 160 kgs

**Dimensions with KB-440 Bin**  
 \*unit sold separately

Height: 73.50" (includes 4" feet)  
 Width: 30"  
 Depth: 34.30"

Bin storage: 442 lbs / 200 kgs

**24 Hour Volume Production**

Air	Water	Production 60 Hz	Production 50 Hz
70°F / 21°C	50°F / 10°C	666 lbs	570 lbs
90°F / 32°C	70°F / 21°C	486 lbs	393 lbs

**Operating Requirements**

	Min	Max
Air Temperatures	50°F / 10°C	100°F / 38°C
Water Temperatures	41°F / 5°C	90°F / 32°C
Water Pressure	14 PSI	72.50 PSI
Electrical Voltage	- 8%	+ 10%



**Specifications**

Model Number	Electrical V / Hz / Ph	BTU's per Hour	Max Fuse Size or HACR Circuit Breaker Amps	Net Weight lb / kgs	Shipping Weight lb / kgs	Refrigerant
KCM-670-AH	208-230 / 60 / 1*	9600	15 A	166 / 75	194 / 88	R-404a
	230 / 50 / 1*	8600	15A	170 / 77	199 / 90	R-404a

\*Unit comes without a cord set or plug. Unit to be connected per local electrical codes.

Electrical V / Hz / Ph	Energy Consumption kWh / 100 lb 90°F (32°C) / 70°F (21°C)	Water Usage / 100 lb of ice @ 90°F air / 70°F water	Plumbing
208-230 / 60 / 1	5.83 kWh	20 gallons / 76 litres	Water Inlet: 3/8" Drain: 3/4"
230 / 50 / 1*	5.34 kWh	20 gallons / 76 litres	Water Inlet: 3/8" Drain: 3/4"

**Ice Maker Dimensions (not including bin) (W x D x H in inches)**

Cabinet: 30" x 24" x 23.50"

Shipping: 32.50" x 27" x 30.25"

Clearance around the unit: left, right, top and rear: 8"

Do not place near ovens, grills or any high heat producing equipment

**Warranty: 3 years parts and labor**

Compressor: 5 years parts and 3 years labor

Valid in United States, Canada & Puerto Rico. Please contact factory for warranty in other countries.

Kool-it is a registered trademark of MVP Group.

Specifications and design are subject to change without prior notice

Replace the filters every 6 months with part #KTI-1



Intertek

Intertek



5659 Royalmount Ave.  
 Montreal, QC, Canada H4P 2P9  
 Telephone: 514.737.9701 / Toll Free: 888.275.4538  
 Fax: 514.342.3854 / Toll Free: 877.453.8832  
 sales@mvpgroupcorp.com / mvpgroupcorp.com

12000 Biscayne Blvd., Suite # 108  
 Miami, FL, United States 33181  
 Telephone: 786.600.4687 / Toll Free: 844.218.8477  
 Fax: 786.661.4100