

# GLASS DOOR MERCHANDISER REFRIGERATOR

## MULTIPLE SWING DOORS

Project Name: \_\_\_\_\_

Project Location: \_\_\_\_\_

Model #: \_\_\_\_\_ Quantity: \_\_\_\_\_

Available Warehouse: \_\_\_\_\_

**EM Series**

**Model: EMSGR69B**



### Refrigeration System

- Bottom mounted, self-contained and fully detachable Blizzard R290 condensing unit uses environmentally friendly, EPA-compliant R290 refrigerant with zero (0) Ozone Depletion Potential (ODP) and three (3) Global Warming Potential (GWP). Blizzard R290 is easily replaceable and requires no on-site brazing.
- Electronically commutated (ECM) fan motors achieve rapid cooling with less energy consumption.
- Full-length air duct ensures optimal cold air distribution.
- Air circulation guard keeps floor vents from obstruction.
- Time-initiated and temperature-terminated auto defrost cycle for seamless operation.
- Large capacity, corrosion-resistant condenser and evaporator coils.
- Self-maintaining, energy-efficient condensate drain pan requires no external drains or electric heaters.
- High performance, auto-reverse condenser fan motor supports compressor ventilation and condenser coil cleaning.
- Pre-wired and ready to plug, 115V/60Hz/1Ph, NEMA 5-15P.

### Cabinet Construction

- Heavy duty white coated steel interior / black exterior.
- Open spaced interior with no walls between compartments.
- Stainless steel floor interior has rounded corners and detachable drain plug for ease of cleaning.
- 2.5" thick high density polyurethane insulation.
- Six height adjustable screw legs.

### Lighting

- Shielded LED bar lighting with on/off switch provides bright, high color illumination at lower heat output.

### Doors

- Low emissivity double glass panes reflect UV rays for efficient cooling.
- Black PVC door frames.
- Self-closing with adjustable torsion system for a positive seal.
- Snap-in magnetic door gasket make cleaning and replacement an easy process.
- High strength, die-cast door handles.

### Shelving

- Four epoxy coated, steel wire shelves with airflow guard per section.
- Height adjustable stainless steel clips.

### Temperature Control

- Multi-function digital controller with easy to read LED display.
- Factory preset temperature, 35°F. Temperature setting range from 33°F to 54°F.
- Audible overheat protection alarm for compressor and condenser coil.

### Options

- Additional shelving.
- 3" swivel casters with locks.
- 3.5" – 6" height-adjustable and interchangeable legs.



Please visit our website for updated Energy Efficiency information

| Ref/<br>Frz/Dual | Doors | Capacity |                | Shelves | Refrigerant | HP  | Power<br>V-Hz-Ph | Amps | Crated<br>Weight   | Exterior Dimensions |                |                     |
|------------------|-------|----------|----------------|---------|-------------|-----|------------------|------|--------------------|---------------------|----------------|---------------------|
|                  |       | Cu. Ft.  | 20 oz. Bottles |         |             |     |                  |      |                    | L                   | D              | H*                  |
| REF              | 3     | 71       | 672            | 12      | R-290       | 3/4 | 115-60-1         | 7    | 697 lbs<br>(316kg) | 72.875"<br>(1851mm) | 32"<br>(813mm) | 80.125"<br>(2035mm) |

(†) Based on evaporating temperature of 23°F (-5°C) & condensing temperature of 131°F (55°C). (►) Product capacity is calculated based on standard industry figures. (✳) Reference plan view for clarification on caster/unit height. If dimensions and capacity are critical, please contact Everest Refrigeration. Blizzard R290 replacement is at the sole discretion of Everest Refrigeration. Specifications subject to change without notice.

# GLASS DOOR MERCHANDISER REFRIGERATOR

## MULTIPLE SWING DOORS

### EM Series Model: EMSGR69B

#### DIMENSIONAL DATA

|                          |    |                  |
|--------------------------|----|------------------|
| External Dimensions      | L  | 72.875" (1851mm) |
|                          | D  | 32" (813mm)      |
|                          | H* | 80.125" (2035mm) |
| Crated Weight            |    | 697 lbs. (316kg) |
| Doors/Drawers/Lids       |    | 3                |
| Max Weight Support (LBS) |    | -                |

#### STORAGE DATA

|                        |     |
|------------------------|-----|
| Net Capacity Cu. Ft. ▶ | 71  |
| Shelves                | 12  |
| Barrels                | -   |
| 20 oz. Bottles         | 672 |
| 12 oz. Bottles         | -   |
| 12 oz. Cans            | -   |
| 8" Mugs                | -   |
| # of Pans (Top)        | -   |
| # of Pans (Drawer)     | -   |
| Dividers               | -   |
| Trays                  | -   |

#### ELECTRICAL DATA

|                        |  |
|------------------------|--|
| Voltage                | 115-60-1   |
| Full Load Amperage     | 7A   |
| Feed Wires with Ground | 3  |
| Cord Length            | 9ft  |
| NEMA Plug Type         |  NEMA 5-15P |

#### REFRIGERATION DATA

|                     |        |
|---------------------|--------|
| Compressor Mounting | Bottom |
| Refrigerant         | R-290  |
| Compressor HP       | 3/4    |
| BTU/HR †            | N/A    |

#### KEY

|    |            |      |               |
|----|------------|------|---------------|
| D  | Door       | R    | Refrigerator  |
| L  | Lid        | REF  | Refrigerator  |
| H  | Half Door  | F    | Freezer       |
| FD | Full Door  | FRZ  | Freezer       |
| SD | Solid Door | DUAL | REF/FRZ Combo |
| GD | Glass Door | DR   | Drawer        |

|  |           |       |      |    |      |
|--|-----------|-------|------|----|------|
|  | Elevation | Right | Plan | 3D | Back |
|  |           |       |      |    |      |

#### PLAN VIEW

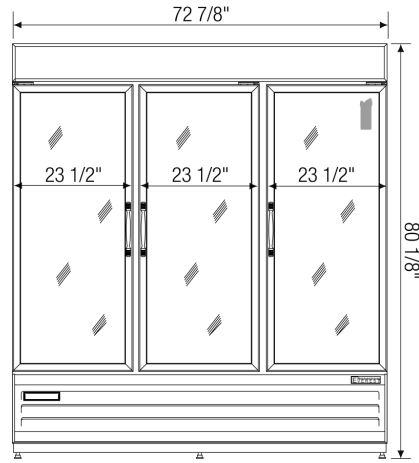

FRONT

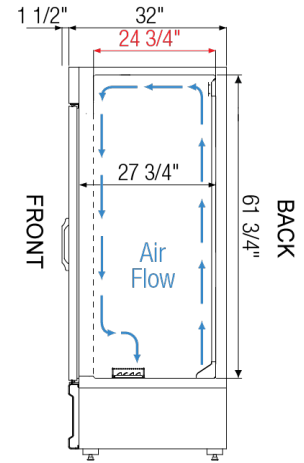

SIDE

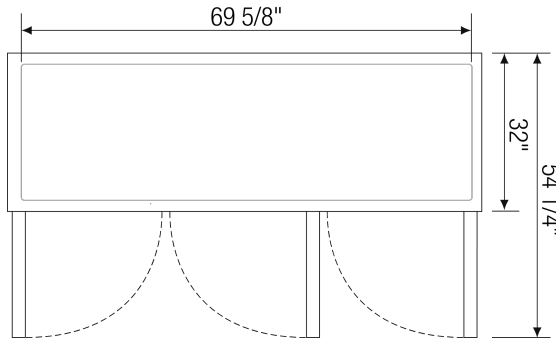

TOP

#### ACCESSORIES & OPTIONS

| Part Number                | Description  |
|----------------------------|--|
| <b>Additional Shelving</b> | Contact Everest Refrigeration for more information.    |
| <b>AJL03-00</b>            | Interchangeable Leg for Caster (Optional)              |
| <b>CASA3-02</b>            | 3" Overall Height Caster Assembly - (3) Front (3) Rear |

(†) Based on evaporating temperature of 23°F (-5°C) & condensing temperature of 131°F (55°C). (▶) Product capacity is calculated based on standard industry figures. (✖) Reference plan view for clarification on caster/unit height. If dimensions and capacity are critical, please contact Everest Refrigeration. Blizzard R290 replacement is at the sole discretion of Everest Refrigeration. Specifications subject to change without notice.