

WINE COOLER
INSTRUCTIONS MANUAL

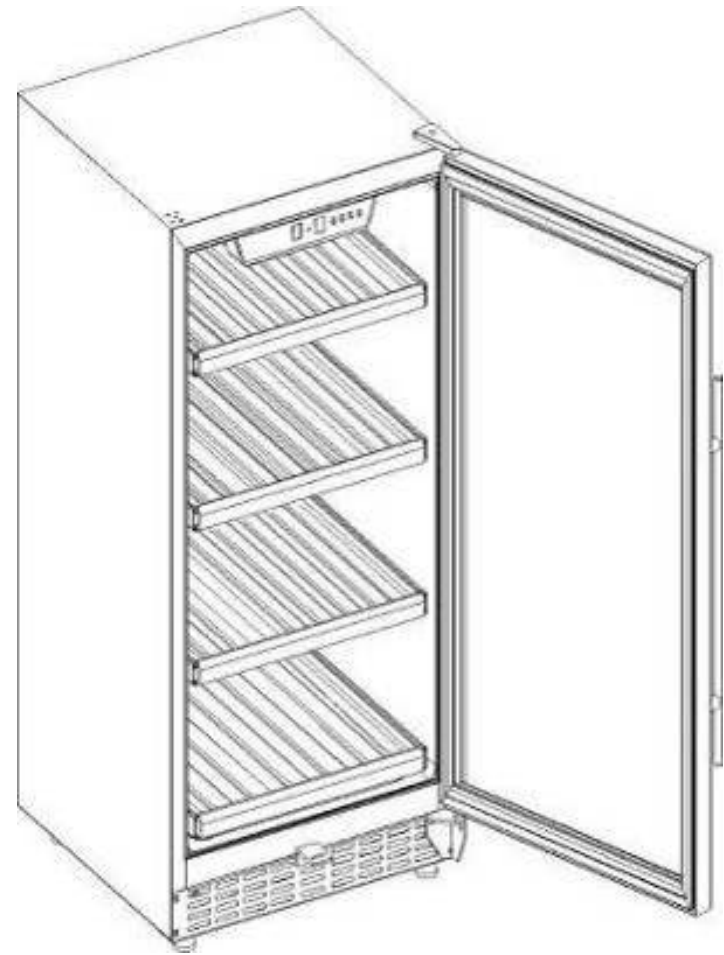

Dear Users:

Thanks for choosing our wine coolers. You will enjoy our kind, prompt and considerate service after you buy our products. This manual would apply to various models of our wine coolers. The model you choose may have a little difference from the description in this manual, but please don't worry about, it will still be useful for you. In order to make it easy for your using, please read this manual carefully and do as the manual guidance. You will be satisfied with it. In addition, we sincerely hope that you will enjoy using our wine coolers.

7. Data Parameters

Model	USZ-54	USZ-72	USZ-128	USZ-168	USF-3 3S USF-33D	USF-54 S USF-54D	USF-72 S USF-72D	USF-128 S USF-128D	USF-168 S USF-168D USF-168T
Climate Type	N								
Volume (L)	161	244	392	445	80 /	161 /	244 /	392 /	445 /
Bottles Capacity	46~52	72~76	128~155	168~177	26~31	46~52	72~76	128~155	168~177
Rated Voltage	AC110~120V/60Hz								
Rated power (W)	1.1A	1.2 A	1.6A	1.7A	1.1A	1.1A	1.2A	1.6A	1.7A
Rated Frequency	100W	110W	130W	140W	90W	100W	110W	130W	140W
Sound (db)	42	42	42	42	42	43	43	45	45
Net Weight (Kg)	49	66	81	103	35	49	66	81	105
Gross Weight (Kg)	53	70	85	109	38	53	70	85	111

Catalogue

Notes -----	4
Structure of Wine Coolers-----	6
Installation -----	12
Operation Instruction -----	13
Care and Maintenance -----	22
Troubleshooting -----	24
Technical Parameters -----	26

1. Important Safety Notes:

⚡Warnings⚡	To reduce the risk of fire, electrical shock, or injury when using your appliance, follow these basic precautions:
<ul style="list-style-type: none"> ● Read all the instructions before using the Wine cooler. ● Keep children away from the wine cooler. Never allow children to operate, play with, or crawl inside the appliance. ● Never clean appliance parts with flammable fluids. Fumes can create a fire hazard or explosion. ● While the wine cooler stops working, please call our after-sale service department or other related technicians to check and repair. Never do it by yourself in case of an accident. ● Once the power cord is damaged, find a professional technician or electrician to change for a new one. Never do it by yourself or continue to use so as to avoid danger. ● Make sure that the plug is pulled while cleaning, moving, or repairing. <p style="text-align: center;">-Keep these instructions-</p>	

⚡Notes⚡

- In order to avoid damage to the door seal, please make sure the door totally opened while pulling out the movable shelves.
- Place the cooler close to the power socket.
- Once the cooler is stored with wines, please do not move it again.
- Make sure the cooler is located in proper place in order to avoid easy access to the compressor in the back.
- Do not start the wine cooler too frequently. The interval should be at least 5 minutes.
- Before throwing away your old wine cooler, take off the door and leave the shelves in their original place so that children may not easily climb inside.

The light does not work.	Not plugged in. The circuit breaker tripped or a fuse has blown. The bulb has burned out. The light button is "OFF".
Vibrations.	Check to ensure that the Wine Cooler is on level.
The Wine Cooler seems to make too much noise.	The rattling noise may come from the flow of the refrigerator, which is normal. As each cycle ends, you may hear gurgling sounds caused by the flow of the refrigerator in your Wine Cooler. Contraction and expansion of the inside walls may cause popping and crackling noises. The Wine Cooler is not on level.
The door will not close properly.	The Wine Cooler is not on level. The door was reversed and not properly installed. The gasket is dirty. The shelves are out of position.

Notes: The replacement of the LED light must be done by a qualified technician. First to unscrew the 2 screws on the light cover, then take out the screw on the LED panel, and replace the LED light of same specification.

Energy Saving Tips

- The Wine Cooler should be located in the coolest area of the room, away from heat producing appliances and out of direct sunlight.

6. Troubleshooting

You can solve many common wine cooler problems easily, saving you the cost of a possible service call. Try the suggestions below to see if you can solve the problem before calling the service.

TROUBLESHOOTING GUIDE

PROBLEM	POSSIBLE CAUSE
Wine Cooler does not operate.	Not plugged in. The appliance is turned OFF. The circuit breaker tripped or a fuse has blown.
Wine Cooler is not cold enough.	Check the temperature control setting. The external environment may require a higher setting. The door is opened too often. The door is not completely closed. The door gasket does not seal properly.
Turn ON and OFF frequently.	The room temperature is hotter than normal. A large amount of contents has been added to the Wine Cooler. The door is opened too often. The door is not completely closed. The temperature control is not set correctly. The door gasket does not seal properly.

- If the wine cooler is operated with R600a, flammable and explosive articles should not be put in or near the cabinet to avoid fire or explosions.
- This appliance is not intended for use by persons (including children) with reduced physical, sensory or mental capabilities, or lack of experience and knowledge, unless they have been given supervision or instructions on the use of the appliance by a person responsible for their safety. Children should be supervised to ensure that they do not play with the appliance.
- If the supply cord is damaged, it must be replaced by the manufacturer, its service agent, or similarly qualified persons in order to avoid a hazard.

2. Structure of Wine Coolers

1.USZ-54/USZ-72/USZ-128 /USZ-168 Series Structure Diagram:



- (1) Control panel (2) Active carbon filter (3) Full wooden shelf
 (4) Sensor (5) Small size wooden Shelf (6) Ventilation base
 (7) Adjustable feet (8) Latch hook (9) Upper hinge
 (10) Glass door (11) Door seal

- Wring excess water out of the sponge or cloth when cleaning the area of controls, or any electrical parts.
- Wash the outside cabinet with warm water and a mild liquid detergent. Rinse well and wipe dry with a clean soft cloth.
- **Reversing The Door Swing Of Your Appliance**
 The door of this appliance has the capability of opening from either the left or right side. The unit is delivered to you with the door opening from the left side. Should you desire to reverse the opening direction, please call customer service for reversal instruction.
- **Power Failure**
 - Most power failures are corrected within a few hours and will not affect the temperature of your appliance if you minimize the frequency of opening the door. If the power is going to be OFF for a longer period of time, you need to take the proper steps to protect your contents.
- **Vacancy Time**
 - **Long vacancy:** If the appliance will not be used for several months, remove all the items and turn OFF the appliance. Clean and dry the interior thoroughly so as to restraint odours and mould. Leave the door slightly open at all time, if necessary.
- **Moving your Wine Cooler**
 - Remove all the items.
 - Securely tape down all loose items (shelves) inside your appliance.
 - Turn the adjustable leg up to the base to avoid damage.
 - Make the door shut.
 - Be sure the appliance stays secure in upright position during transportation. Also protect the outside of the appliance with a blanket or any similar item.

NOTE: All parts removed must be saved to allow the door swing to be reversed.

1. Use sharp tools to carefully pry open the decoration nail on top of the cabinet and cap of the door spindle (Fig. 1).
2. Open the door to an angle, unscrew the screw of the door hinge's cover, remove the cover of the upper door hinge, and unscrew all the screws on the upper door hinge. Be careful to hold the glass door firmly after removing the screws and take off the door (Fig. 2).
3. Remove the screw of the lower door hinge and left side screw of the front vent (Fig. 3); then, install the lower door hinge at the designated position on the opposite side (Fig. 4).
4. Remove the screw of the door handle, remove the bottom screw on left side of the door, and remove the lower supporter of the door (Fig. 5). Install the lower support of the door to the opposite side (Fig. 6).
5. Pull open the middle section of the door gasket to make the handle screw hole come out (Fig. 7). Remove the handle and install it on the opposite side (Fig. 8).
6. Install the upper door hinge to the opposite side and tighten the screws (Fig. 9).
7. Set the glass door shaft to aim the shaft of the lower door hinge (Fig. 10); then, aim the upper door hinge (Fig. 11). Adjust the door so that the cabinet is aligned and leveled; then, tighten all the lock screws.

You also can call customer service for reversal instructions, if necessary.

5. Care and Maintenance

Cleaning Your Wine Cooler

- Wash the inside surfaces with warm water and a baking soda solution. The solution should be about 2 tablespoons of baking soda with one quart of water.
- Wash the shelves with a mild detergent solution.
- Turn OFF the power, unplug the appliance, and remove all the items including shelves and racks.

2. USF-33S Series Structure Diagram:

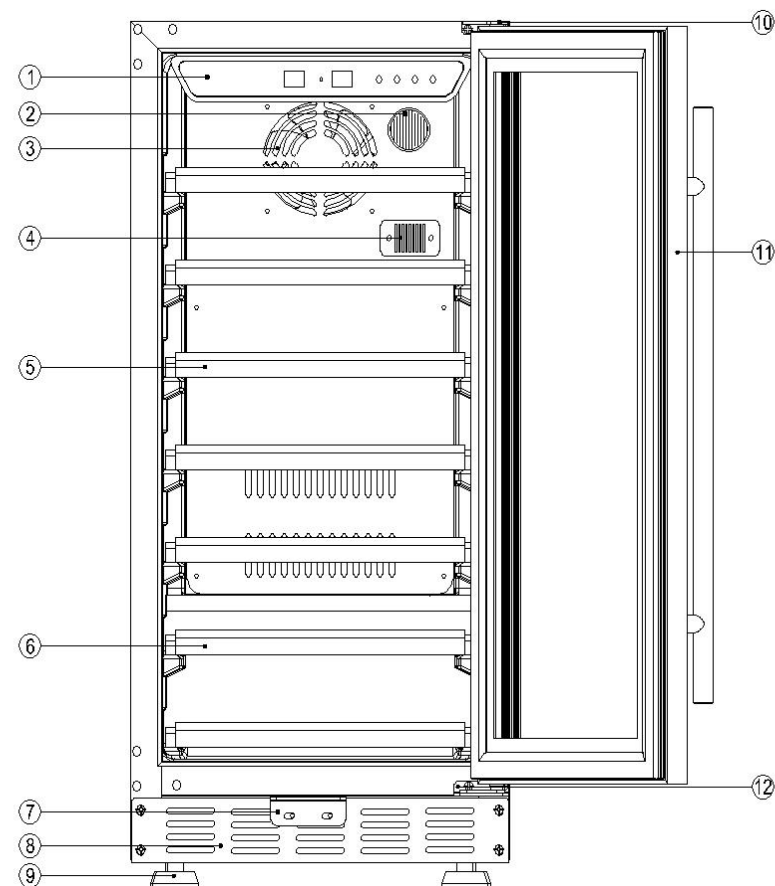

- (1) Control panel (2) Active carbon filter (3) Ventilation fan (4) Sensor
(5) Big shelf (6) Small shelf (7) Latch hook (8) Ventilation base
(9) Adjustable feet (10) Upper hinge (11) Glass door (12) Lower hinge

3.USF-54S/USF-72S/USF-128S/USF-168S Series Structure Diagram:

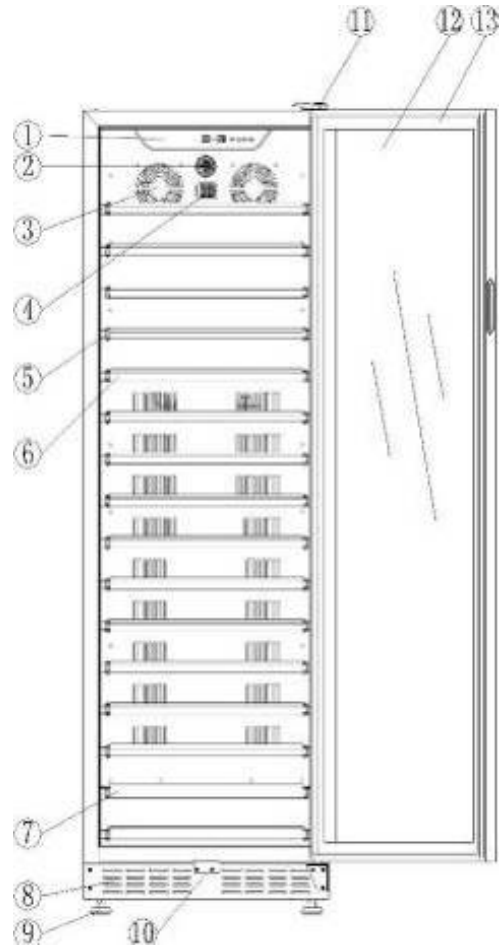

- (1) Control panel (2) Active carbon filter (3) Ventilation fan (4) Sensor
- (5) Sliding guide (6) Full wooden shelf (7) Small size wooden shelf
- (8) Ventilation base (9) Adjustable feet (10) Latch hook hinge (11) Upper hinge
- (12) Glass door (13) Door seal

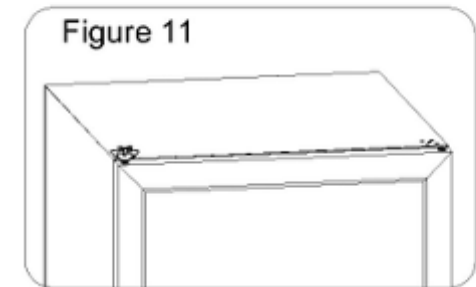
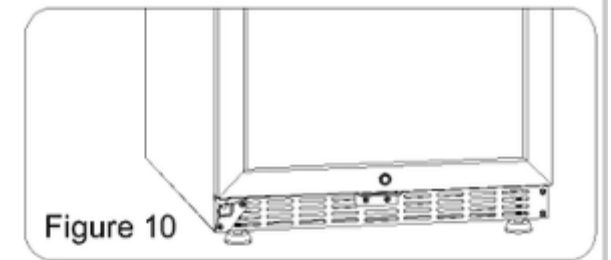
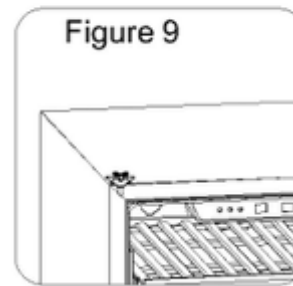
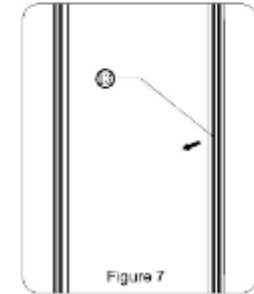
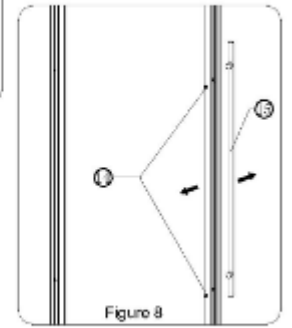
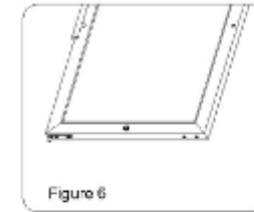
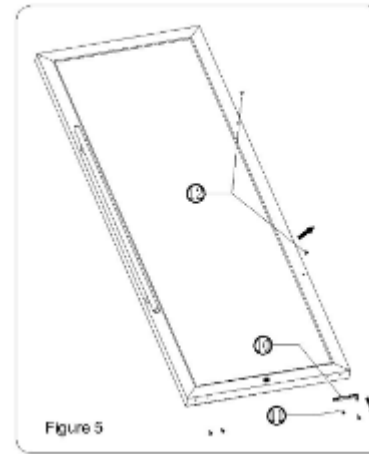

Your cabinet was designed to store a maximum number of bottles safely. The wines are kindly advised to layout equally.

The best temperature for red wines is 10-18°C (50-64°F) and 5-12°C (41-50°F) for white wines. The temperature range of our wine coolers could be set between 5-18°C (41-64°F).

© **Reversing the door swing of your appliance**

The unit is delivered to you with the door opening from the left side (hinge on the right side). The door of this appliance is capable of opening from either the left or right side. To reverse the door swing of your cooler and open from the right side, please follow the instructions and diagram below.

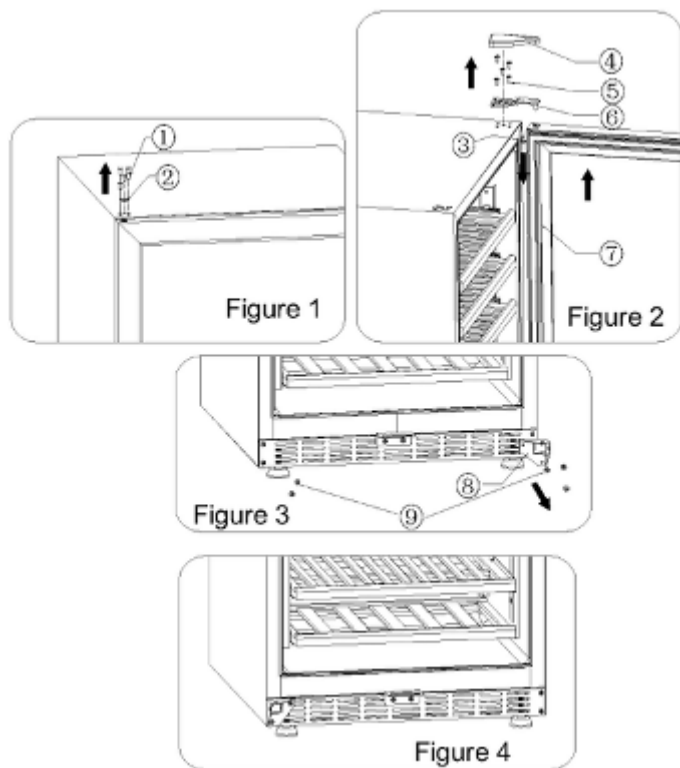

4.USF-33D Series Structure Diagram:

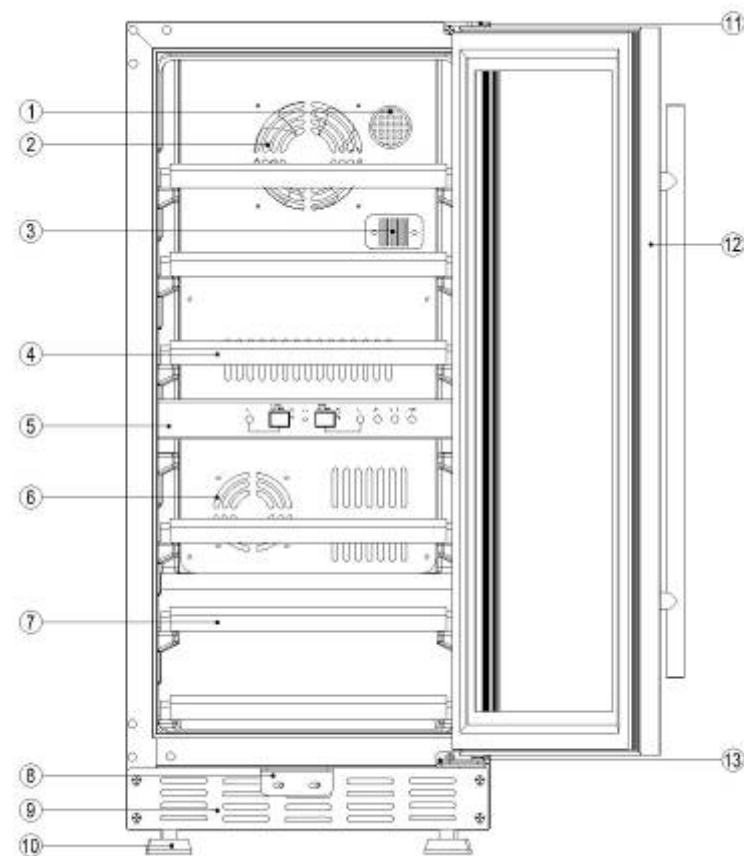

- (1) Active carbon filter (2) Ventilation fan (3) Sensor (4) Big shelf
- (5) Control panel (6) Heater fan (7) Small shelf (8) Latch hook
- (9) Ventilation base (10) Adjustable feet (11) Upper hinge
- (12) Glass door (13) Lower hinge

5.USF-54D/USF-72D/USF-128D/USF-168D Series Structure Diagram:

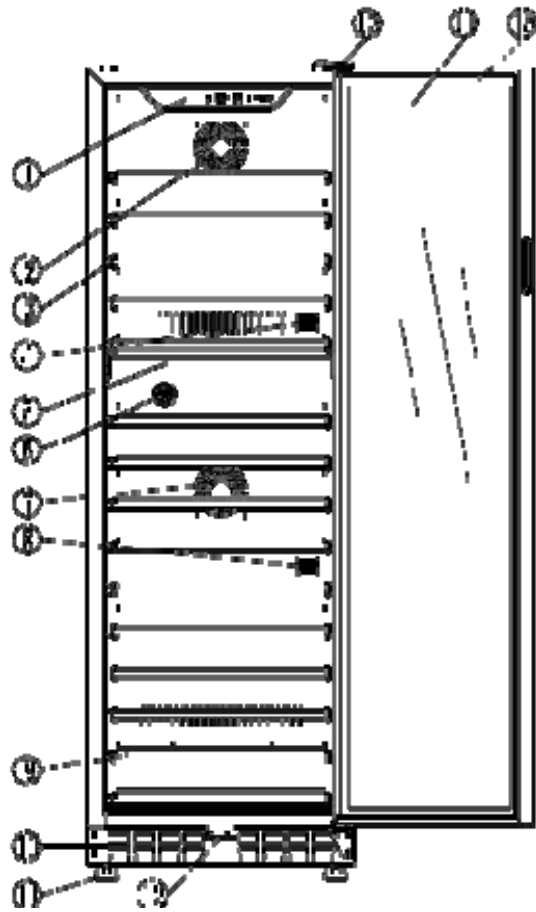

- (1) Control panel (2) Ventilation fan (3) Full wooden shelf (4) Sensor
- (5) Baffle plate (6) Active carbon filter (7) Ventilation fan (8) Sensor
- (9) Small size wooden shelf (10) Ventilation base (11) Adjustable feet
- (12) Latch hook (13) Upper hinge (14) Glass door (15) Door seal

◎ *Wine Placement and Storage*

Several common wine layouts:

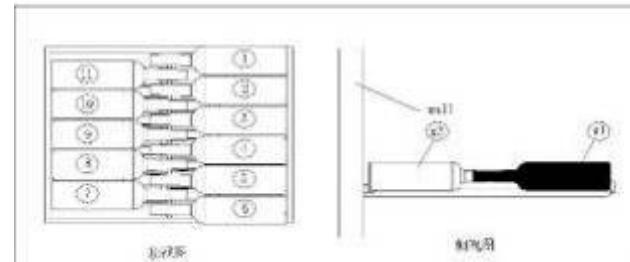
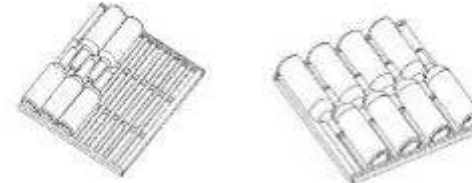
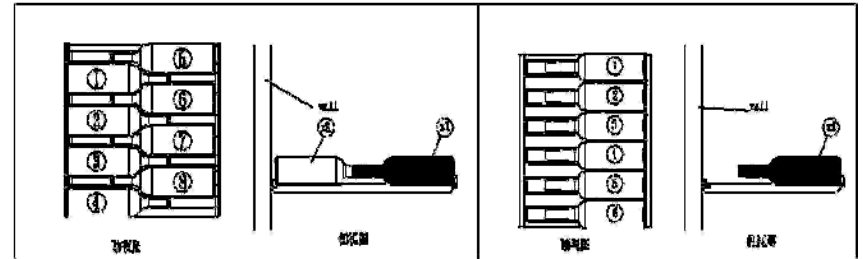

- **°C/°F button:** Celsius and Fahrenheit conversion button.

- **ON/OFF button:** Power ON and OFF button.

Note: This series of wine coolers has its delay protection function. The compressor will start to work about 3 to 5 minutes after it is powered ON or OFF. Please use the wine cooler under the N type of climate. The temperature inside the cabinet will fluctuate and influence the refrigerating effect if the surrounding temperature is too hot or too cold.

◎ **Shelf Change**

Pull out or change the shelves as shown below:

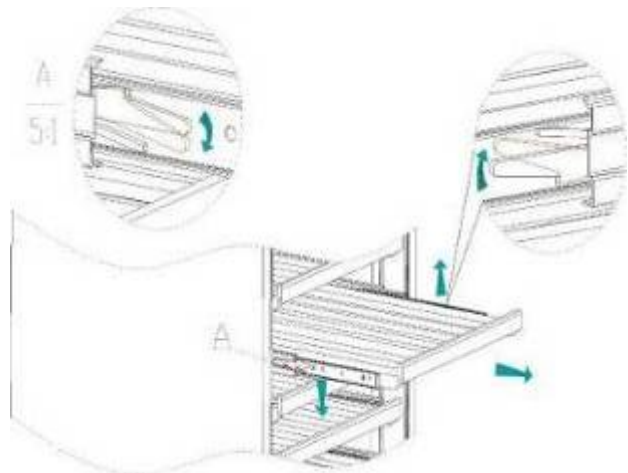

First, take out all the wines from the shelves and pull each shelf out to the limit. Then, press down the left limit of the sliding rail and while pressing up the right one, pull the shelves out at this point. Shelves can be easily pulled out if the three steps (press down the left limit, press up the right one, and pull out) are done at the same time.

Second, push up the sliding rail, make the front hook pop out of the shelf bracket, and simply pull the sliding rail outward. The shelves can be easily pulled out the shelf bracket at this point. Proceed in reverse order for installation.

5. USF-168T Series Structure Diagram:

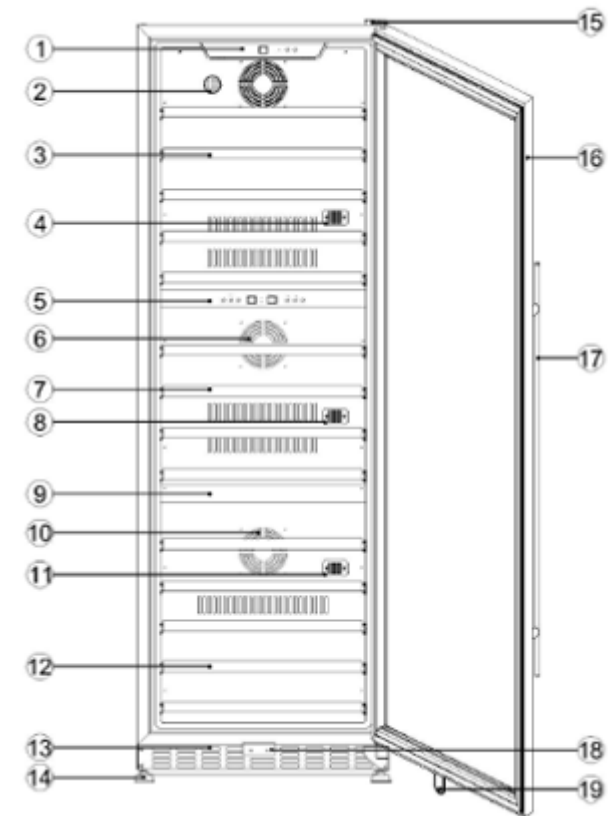

- (1) Control panel (2) Active carbon filter (3) Big wooden shelf (4) Sensor
- (5) Baffle plate (6) Middle ventilation fan (7) Big wooden shelf (8) Sensor
- (9) Baffle plate (10) Lower ventilation fan (11) Sensor (12) Small wooden shelf
- (13) Ventilation base (14) Adjustable feet (15) Upper hinge (16) Door seal
- (17) Glass door (18) Lock keeper (19) Lock hook

3.Installation

➤ Before Using your Wine Cooler

- Remove the exterior and interior packing.
- Before connecting the Wine Cooler to the power source, let it stand upright for approximately 24 hours. This will reduce the possibility of a malfunction in the cooling system from handling during transportation.
- Clean the interior surface with lukewarm water and a soft cloth.
- The cooler is specially designed for wine storage, please do not store other goods.

➤ Installation:

- The cooler should be placed apart to ensure good heat dissipation. The back of the cooler should be at least 10 cm away from the wall.
- To level your Wine Cooler, adjust the front leveling leg at the bottom of the Wine Cooler.
- Place the Wine Cooler away from direct sunlight and sources of heat (stove, heater, radiator, etc.). Direct sunlight may affect the acrylic coating and heat sources may increase electrical consumption. Extreme cold ambient temperatures may also cause the unit to perform improperly.
- Avoid placing the unit in damp areas.
- Plug in the proper power socket. Make sure that the shape and voltage of the socket is compliant with the nameplate on the back of the cooler.

- **UPPER CHAMBER:** Display of the actual temperature of the upper chamber. The range is 0°C~37°C or 32°F~99°F.

- **LOWER CHAMBER:** Display of the actual temperature of the lower chamber. The range is 0°C~37°C or 32°F~99°F.

- **°C/°F light:** The °C light displays the temperature in Celsius and the °F light displays the temperature in Fahrenheit.

◎ Button Operation

- **SET button of the upper chamber:** Temperature setting button. Once you press the button, the temperature increases to 1°C or 1°F. The setting range is between 5°C~18°C or 41°F~64°F.

- **SET button of the lower chamber:** Temperature setting button. Once you press the button, the temperature increases to 1°C or 1°F. The setting range is between 5°C~10°C or 41°F~50°F.

- **SET button of the lower chamber:** Temperature setting button. Once you press the button, the temperature increases to 1°C or 1°F. The setting range is between 10°C~18°C or 50°F~64°F.

- **LIGHT button:** Cabinet light control button. **Note:** Once the light is turned ON, it will automatically turn OFF after 10 minutes to protect the wines inside.

4.3. Control Panel Below (Triple zone):



(Upper Control Panel)

◎ Display Windows

- **RUN light:** Indicator light of compressor working. When the compressor is in operation, the red light is ON and the red light is OFF when it stops operating.

◎ Button Operation

- **SET button:** Temperature setting button. Once you press the button, the temperature increases to 1°C or 1°F. The setting range is between 5°C~18°C or 41°F~64°F.

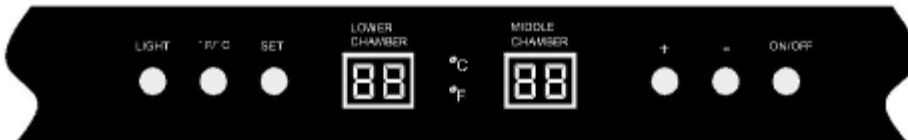

(Lower Control Panel)

◎ Display Windows

- **RUN light:** Indicator light of compressor working. When the compressor is in operation, the red light is ON and the red light is OFF when it stops operating.

4. Operation Instruction

4.1 Control Panel Below (Single Zone):



◎ Display Windows

- **RUN light:** Indicator light of compressor working. When the compressor is in operation, the red light is ON and the red light is OFF when it stops operating.
- **SETTING:** Display of your set temperature. The temperature setting range is 5°C~18°C or 41°F~64°F.
- **CHAMBER:** Display of the actual temperature inside the cabinet. The range is 0°C~37°C or 32°F~99°F.
- **°C/°F light:** The °C light displays the temperature in Celsius and the °F light displays the temperature in Fahrenheit.

◎ Button Operation

- **SET button:** Temperature setting button. Once you press the button, the temperature increases to 1°C or 1°F. The setting range is between 5°C~18°C or 41°F~64°F.
- **LIGHT button:** Cabinet light control button. **Note:** Once the light is turned ON, it will automatically turn OFF after 10 minutes to protect the wines inside.
- **°C/°F Button:** Celsius and Fahrenheit conversion button.
- **ON/OFF button:** Power ON and OFF button.

4.2 Control Panel Below (Dual Zone):

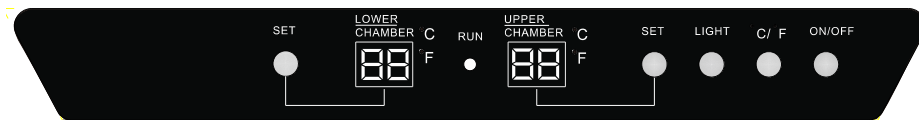

◎ Display Windows

- **RUN light:** Indicator light of compressor working. When the compressor is in operation, the red light is ON and the red light is OFF when it stops operating.
- **UPPER CHAMBER:** Display of the actual temperature of the upper chamber. The range is 0°C~37°C or 32°F~99°F.
- **LOWER CHAMBER:** Display of the actual temperature of the lower chamber. The range is 0°C~37°C or 32°F~99°F.
- **°C/°F light:** The °C light displays the temperature in Celsius and the °F light displays the temperature in Fahrenheit.

◎ Button Operation

- **SET button of the upper chamber:** Temperature setting button. Once you press the button, the temperature increases to 1°C or 1°F. The setting range is between 5°C ~18°C or 41°F~64°F.
- **SET button of the lower chamber:** Temperature setting button. Once you press the button, the temperature increases to 1°C or 1°F. The setting range is between 10°C ~18°C or 50°F~64°F.
- **LIGHT button:** Cabinet light control button. **Note:** Once the light is turned ON, it will automatically turn OFF after 10 minutes to protect the wines inside.
- **°C/°F Button:** Celsius and Fahrenheit conversion button.
- **ON/OFF button:** Power ON and OFF button.

Note: This series of wine coolers has its delay protection function. The compressor will start to work about 3 to 5 minutes after it is powered ON or OFF. Please use the wine cooler under the N type of climate. The temperature inside the cabinet will fluctuate and influence the refrigerating effect if the surrounding temperature is too hot or too cold.