



Indoor Walk-in Box

PROJECT: _____

MODEL #: _____

QUANTITY: _____

APPROVAL: _____

For Commercial Use Only

8.2' x 11.48' x 7.5' (Without Floor) Technical Drawing

DOOR ON 8.2' SIDE

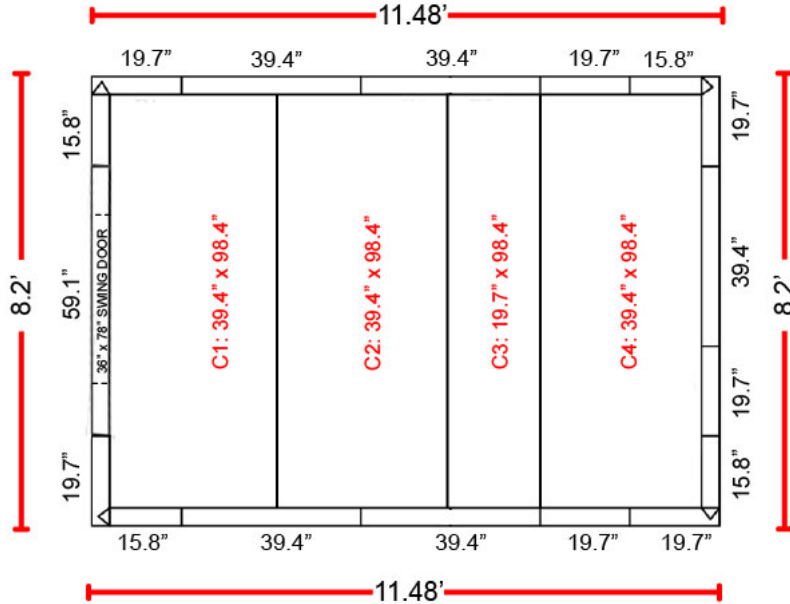

CONSTRUCTION

Name	Model	Size	QTY
Wall Panel	WP-3982	39.4" x 82.1"	5
	WP-1982	19.7" x 82.1"	3
	WP-1982-C	19.7" x 82.1" (Corner)	4
	WP-1582-C	15.8" x 82.1" (Corner)	4
Ceiling Panel	CF-3998-H	39.4" x 98.4" (Hook)	1
	CF-3998-B	39.4" x 98.4" (Bolt)	1
	CF-3998	39.4" x 98.4"	1
	CF-1998	19.7" x 98.4"	1
Door Panel	DP-5982	59.1" x 82.1"	1
Accessories	U-Channel	433" long in total	
	Plastic Plug	100 pcs in total	

NOTE

- * 1 x CP191982 = 1 x WP-1982-C + 1 x WP-1582-C
- * 1 x WP-3982 = 2 x WP-1982 1 x CF-3998 = 2 x CF-1998
- * U-Channel: For no floor boxes only (trim u-channel from door opening for roll in access).

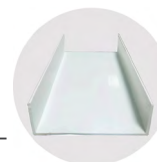

U-Channel



Plastic Plug





Indoor Walk-in Box

PROJECT: _____

MODEL #: _____

QUANTITY: _____

APPROVAL: _____

For Commercial Use Only

8.2' x 11.48' x 7.5' (Without Floor) Technical Drawing

DOOR ON 11.48' SIDE

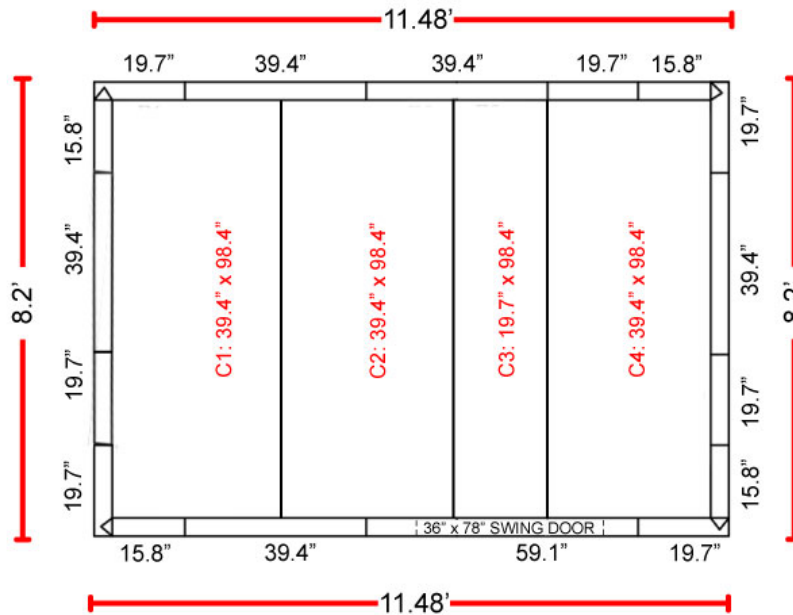

CONSTRUCTION

Name	Model	Size	QTY
Wall Panel	WP-3982	39.4" x 82.1"	5
	WP-1982	19.7" x 82.1"	3
	WP-1982-C	19.7" x 82.1" (Corner)	4
	WP-1582-C	15.8" x 82.1" (Corner)	4
Ceiling Panel	CF-3998-H	39.4" x 98.4" (Hook)	1
	CF-3998-B	39.4" x 98.4" (Bolt)	1
	CF-3998	39.4" x 98.4"	1
	CF-1998	19.7" x 98.4"	1
Door Panel	DP-5982	59.1" x 82.1"	1
Accessories	U-Channel	433" long in total	
	Plastic Plug	100 pcs in total	

NOTE

- * 1 x CP191982 = 1 x WP-1982-C + 1 x WP-1582-C
- * 1 x WP-3982 = 2 x WP-1982 1 x CF-3998 = 2 x CF-1998
- * U-Channel: For no floor boxes only (trim u-channel from door opening for roll in access).

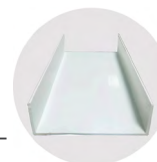

U-Channel



Plastic Plug





Indoor Walk-in Box

PROJECT: _____

MODEL #: _____

QUANTITY: _____

APPROVAL: _____

For Commercial Use Only

8.2' x 11.48' x 7.5' (With Floor) Technical Drawing

DOOR ON 8.2' SIDE

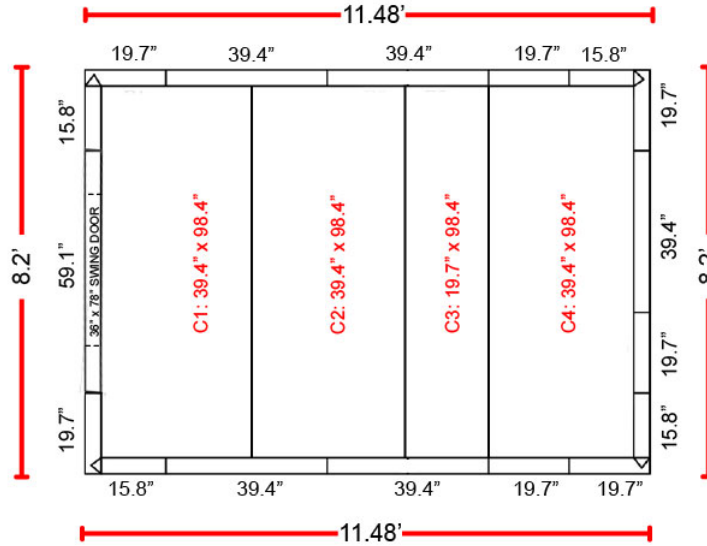

CONSTRUCTION

Name	Model	Size	QTY
Wall Panel	WP-3982	39.4" x 82.1"	5
	WP-1982	19.7" x 82.1"	3
	WP-1982-C	19.7" x 82.1" (Corner)	4
	WP-1582-C	15.8" x 82.1" (Corner)	4
Ceiling Panel	CF-3998-H	39.4" x 98.4" (Hook)	1
	CF-3998-B	39.4" x 98.4" (Bolt)	1
	CF-3998	39.4" x 98.4"	1
	CF-1998	19.7" x 98.4"	1
Door Panel	DP-5982	59.1" x 82.1"	1
Floor Panel	CF-3998-H	39.4" x 98.4" (Hook)	1
	CF-3998-B	39.4" x 98.4" (Bolt)	1
	CF-3998	39.4" x 98.4"	1
	CF-1998	19.7" x 98.4"	1
Threshold Cover	DPL-0404	39" x 4"	1
Plastic Plug	104 pcs in total		

NOTE

- * 1 x CP191982 = 1 x WP-1982-C + 1 x WP-1582-C
- * 1 x WP-3982 = 2 x WP-1982 1 x CF-3998 = 2 x CF-1998
- * Floor Panel = Ceiling Panel



Plastic Plug



USR Brands, Inc.

Phone: 800-764-1172 | www.usrbrands.com | sales@usrbrands.com

Rev. 07-2023

Page 839



Indoor Walk-in Box

PROJECT: _____

MODEL #: _____

QUANTITY: _____

APPROVAL: _____

For Commercial Use Only

8.2' x 11.48' x 7.5' (With Floor) Technical Drawing

DOOR ON 11.48' SIDE

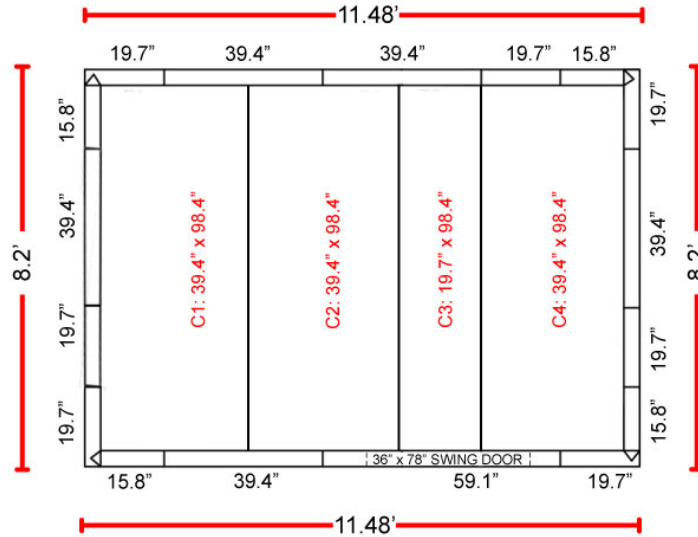

CONSTRUCTION

Name	Model	Size	QTY
Wall Panel	WP-3982	39.4" x 82.1"	5
	WP-1982	19.7" x 82.1"	3
	WP-1982-C	19.7" x 82.1" (Corner)	4
	WP-1582-C	15.8" x 82.1" (Corner)	4
Ceiling Panel	CF-3998-H	39.4" x 98.4" (Hook)	1
	CF-3998-B	39.4" x 98.4" (Bolt)	1
	CF-3998	39.4" x 98.4"	1
	CF-1998	19.7" x 98.4"	1
Door Panel	DP-5982	59.1" x 82.1"	1
Floor Panel	CF-3998-H	39.4" x 98.4" (Hook)	1
	CF-3998-B	39.4" x 98.4" (Bolt)	1
	CF-3998	39.4" x 98.4"	1
	CF-1998	19.7" x 98.4"	1
Threshold Cover	DPL-0404	39" x 4"	1
Plastic Plug	104 pcs in total		

NOTE

- * 1 x CP191982 = 1 x WP-1982-C + 1 x WP-1582-C
- * 1 x WP-3982 = 2 x WP-1982 1 x CF-3998 = 2 x CF-1998
- * Floor Panel = Ceiling Panel



Plastic Plug



USR Brands, Inc.
 Phone: 800-764-1172 | www.usrbrands.com | sales@usrbrands.com