

# CRESCENDO, 120/208-240V

31.3" x 18.9" x 14.0"  
(79.5cm x 48.0cm x 35.6cm)



- Precision burrs are used for clean-cut milling of the beans and assurance of superior grounds production
- Engineered with three powder hoppers: two 3.3 lb (1.5 kg) hoppers for larger demand flavors and one 2.2 lb (1 kg) hopper for an additional selection
- Prominent 2.2 lb (1 kg) bean hopper allows for full visibility of fresh whole beans
- Spent pucks are automatically deposited in a 70-puck capacity holding bin: optionally, spent pucks may be eliminated via a through-counter chute
- Touchpad features two programmable portion sizes of 8 to 12 oz (230 to 350 ml) each, up to nine beverage choices, plus hot water
- Compact footprint
- Bright, high-visibility nozzle defines the 5.5" (140.5 mm) height of the dispense area
- 9 bar pressure assures optimal extraction and, coupled with a variable brew group, produces superb single or double shots, each finished with a handsome crema
- Adjustable speed auger motors deliver reliable performance, routinely fulfilling ingredient portioning requirements
- Designed, engineered and assembled by BUNN in the USA

Agency:



## Specifications

**Product #:** 44300.0240

**Water Access:** Plumbed

**Finish:** Stainless/Black

## Additional Features

Hot Water Button

## Electrical & Capacity

Volts	Amps	Watts	Cord Attached	Plug Type	8oz cups/hr 236ml cups/hr	Input H <sub>2</sub> O Temp.	Phase	# Wires plus Ground	Hertz
120/208-240	13.5-15.3	2800/3670	Yes	NEMA L14-20P	40	60°F (15.5°C)	1	3	60

## Plumbing Requirements

PSI	kPa	Fitting Supplied	Water Flow Required (GPM)
20-90	138-621	3/4" BSPP	0.50

## CAD Drawings

2D	Revit	KLC
●		



BUNN® reserves the right to change specifications and product design without notice. Such revisions do not entitle the buyer to corresponding changes, improvements, additions or replacements for previously purchased equipment. For most current specifications and other info visit [bunn.com](http://bunn.com).

Created on:  
01/01/2019

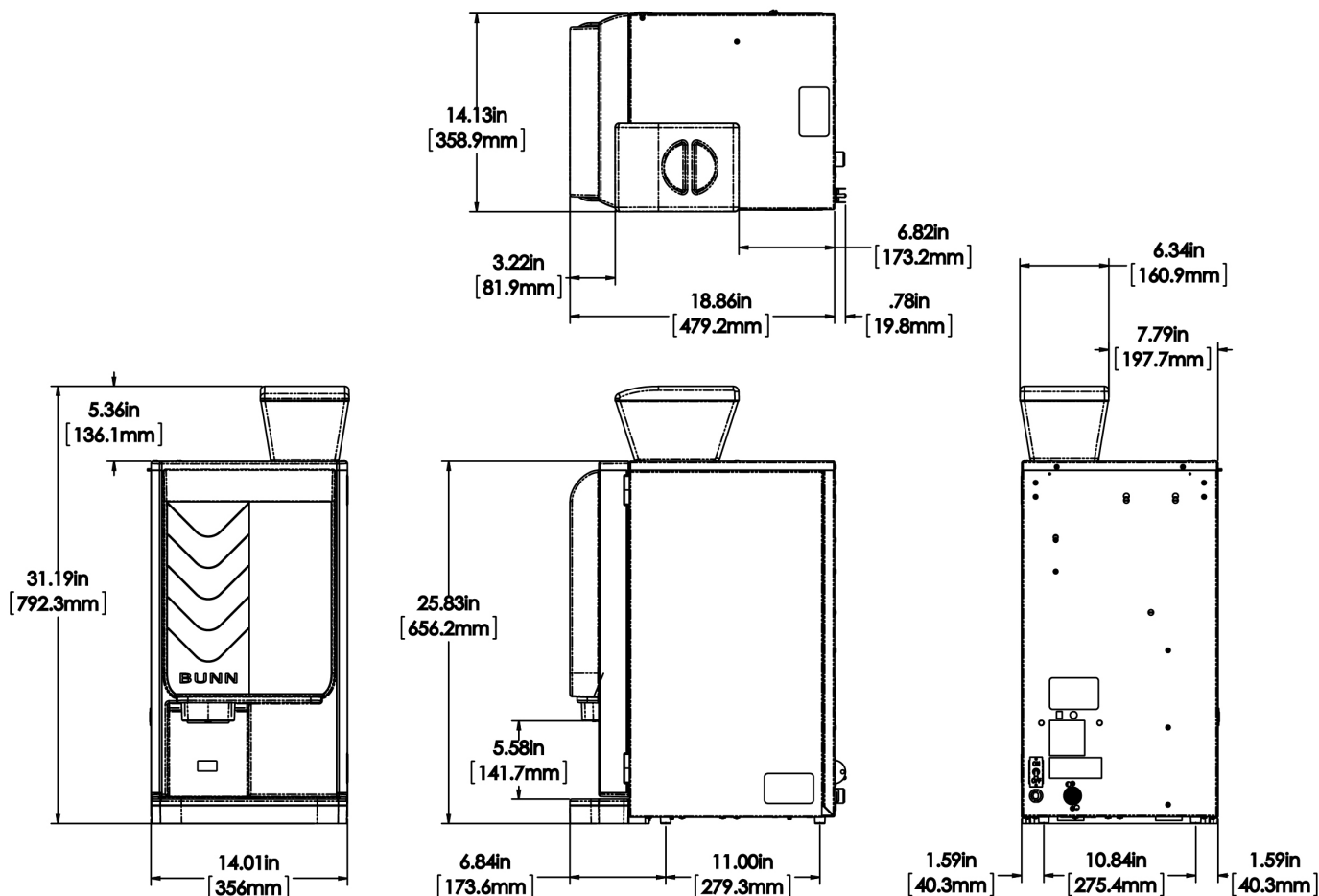

Unit				Shipping				
	Width	Height	Depth	Width	Height	Depth	Weight	Volume
English	14.0 in.	31.3 in.	18.9 in.	17.8 in.	36.8 in.	25.3 in.	101.000 lbs	9.591 ft³
Metric	35.6 cm	79.5 cm	48.0 cm	45.2 cm	93.5 cm	64.3 cm	45.814 kgs	0.272 m³



BUNN® reserves the right to change specifications and product design without notice. Such revisions do not entitle the buyer to corresponding changes, improvements, additions or replacements for previously purchased equipment. For most current specifications and other info visit [bunn.com](http://bunn.com).

Created on:  
01/01/2019

Related Products & Accessories:CRESCENDO, 120/208-240V(44300.0240)



BRUSH, TUBE-NYL  
BRISTLE .25 OD

Product #: 26367.0000



CLEANING TABLETS,  
CAFIZA 100T

Product #: 36000.1189



CARTRIDGE,  
EQHP-10LCRTG

Product #: 39000.1001

BRUSH, TUBE-  
BRISTLE .50 OD

Product #: 49827.0000

KEY, PL518-101 SI 312

Product #: 52444.0020



## Serving & Holding Options: CRESCENDO, 120/208-240V(44300.0240)

\*Serving and Holding selections are currently unavailable. Please contact your sales representative to find out more information.\*



BUNN® reserves the right to change specifications and product design without notice. Such revisions do not entitle the buyer to corresponding changes, improvements, additions or replacements for previously purchased equipment. For most current specifications and other info visit [bunn.com](http://bunn.com).

Created on:  
01/01/2019