

*Blueair by*  
**BLUENIX**

**MODEL BOD-72G**

# OPEN DISPLAY CASES

Sleek and durable cooling solution for  
your food and beverages.



Conforms to NSF/ANSI 7(ETL)



## MODEL BOD-72G OPEN DISPLAY CASES

### Exterior Dimensions (inches/mm)

L	D	H
72 1/8" 1831 mm	32 3/4" 831 mm	80 3/4" 2050 mm

### Weight (lbs/kg)

Net Weight	Ship Weight
791 lbs 358 kg	836 lbs 379 kg

*Blueair by*  
**BLUENIX**

Blue Air has right to change specifications without further notice.

## Cabinet construction

- Pre-coated steel interior and exterior
- High density foamed in place polyurethane insulation - Environmentally safe
- Perforated interior rear wall and top vents for more efficient air circulation cooling
- Standard night curtain
- Four (4) 1" height adjustable shelves

## Refrigeration

- R-404A Refrigerant.
- Self-contained system, bottom mounted compressor provides quick and easy maintenance.
- Innovative hot gas frame heating system reduces condensation and increases energy efficiency.
- Front air intake and rear air vent circulation system.
- Temperature range between 38°F ~ 44°F

## Optional Features & Accessories

- Glass side panel

### Front view

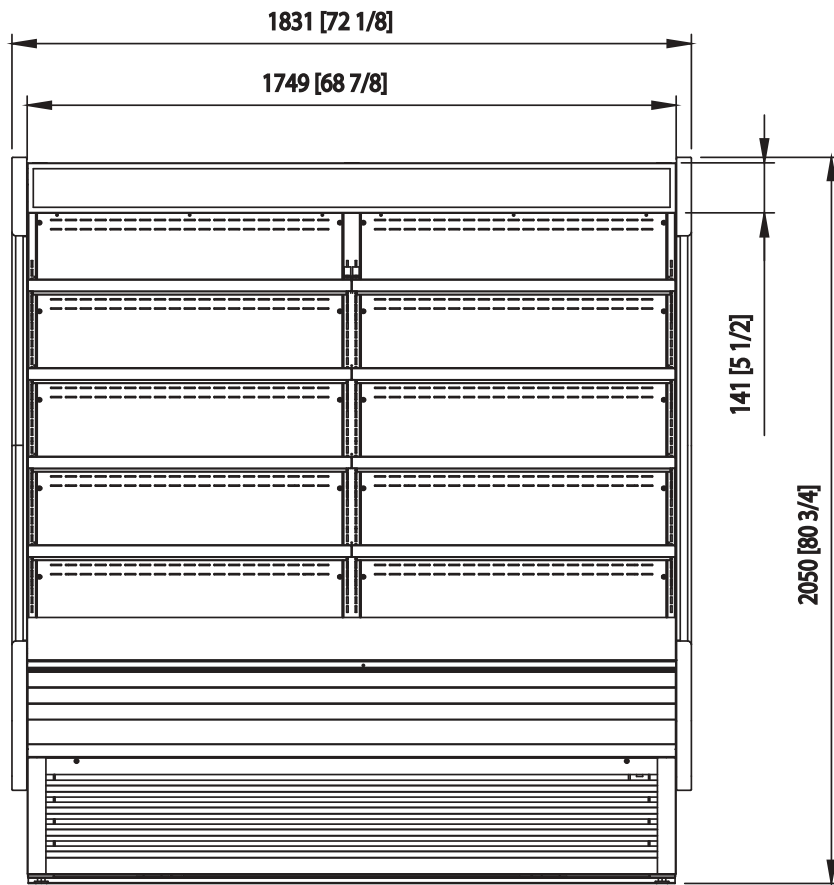

### Side view

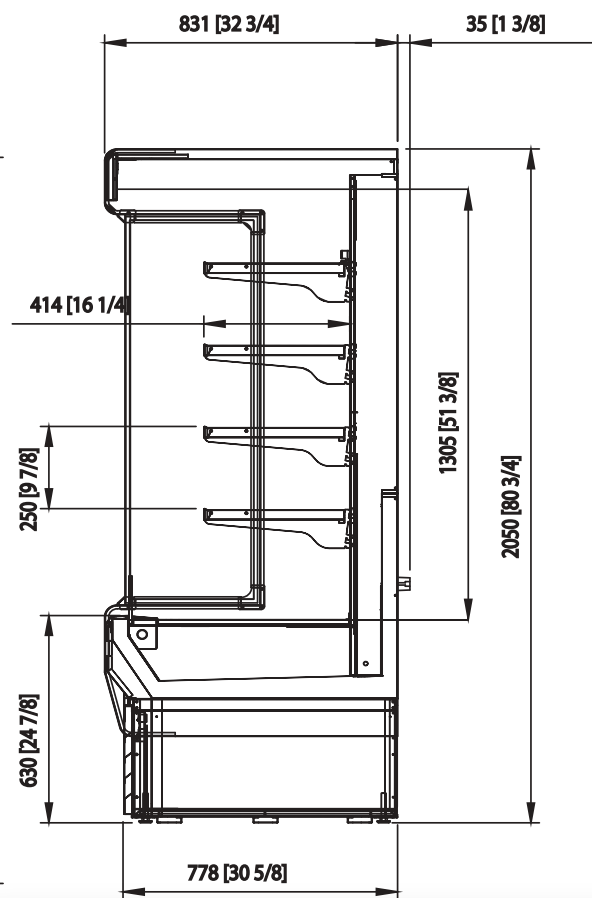

### Top view

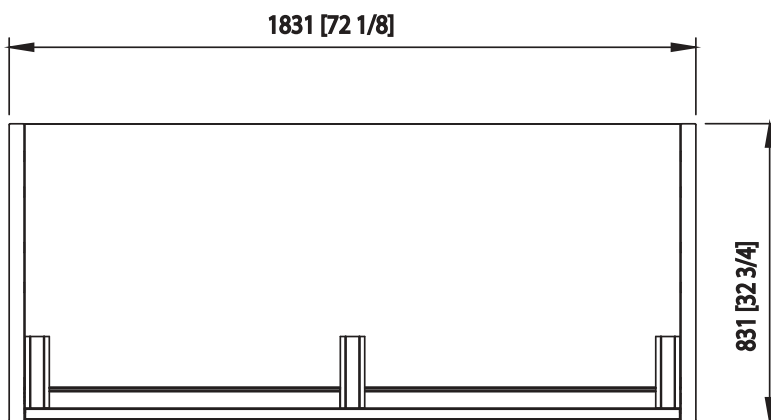

Capacity Cu.Ft.	41
Shelves	8
Refrigerant	R-404 A
Temperature Range	38°F ~ 44°F
Easy Maintenance	Sliding Condensing Unit
Connection	9.8 ft long (3m) flexible three wire cord with modeled plug
Lighting	LED Interior lighting
HP	1 x 2
Voltage	115V/208~230V 60Hz
Amps	15
NEMA Config.	NEMA L14 -20



- This product may expose you to chemicals including Diisononyl Phthalate(DINP), which is known to the State of California to cause cancer. For more information go to [www.P65Warnings.ca.gov](http://www.P65Warnings.ca.gov).  
 - Ce produit peut vous exposer à des agents chimiques incluant le Diisononyl Phthalate(DINP), reconnu par l'Etat de Californie comme causant le cancer, Pour de plus amples renseignements, consulter le site [www.P65Warnings.ca.gov](http://www.P65Warnings.ca.gov).



[blueairfse.com](http://blueairfse.com)



[orders@blueairfse.com](mailto:orders@blueairfse.com)



223 W. Rosecrans Ave., CA 90248  
T: 310-808-0102

9 W. Shelton Terrace #A, Hillside, NJ 07205  
T: 470-625-0182

7025 Amwiler industrial Drive, Suite A, Atlanta GA  
T: 908-688-0970