

Blueair by BLUENIX

MODEL BOD-48G

OPEN DISPLAY CASES

Sleek and durable cooling solution for
your food and beverages.



Conforms to NSF/ANSI 7(ETL)



MODEL BOD-48G OPEN DISPLAY CASES

Exterior Dimensions (inches/mm)

L	D	H
48 1/8"	32 3/4"	80 3/4"
1221 mm	831 mm	2050 mm

Weight (lbs/kg)

Net Weight	Ship Weight
560 lbs 254 kg	604 lbs 274 kg

Cabinet construction

- Pre-coated steel interior and exterior
- High density foamed in place polyurethane insulation - Environmentally safe
- Perforated interior rear wall and top vents for more efficient air circulation cooling
- Standard night curtain
- Four (4) 1" height adjustable shelves

Refrigeration

- R-404A Refrigerant.
- Self-contained system, bottom mounted compressor provides quick and easy maintenance.
- Innovative hot gas frame heating system reduces condensation and increases energy efficiency.
- Front air intake and rear air vent circulation system.
- Temperature range between 38°F ~ 44°F

Optional Features & Accessories

- Glass side panel

Blueair by
BLUENIX

Blue Air has right to change specifications without further notice.

Front view

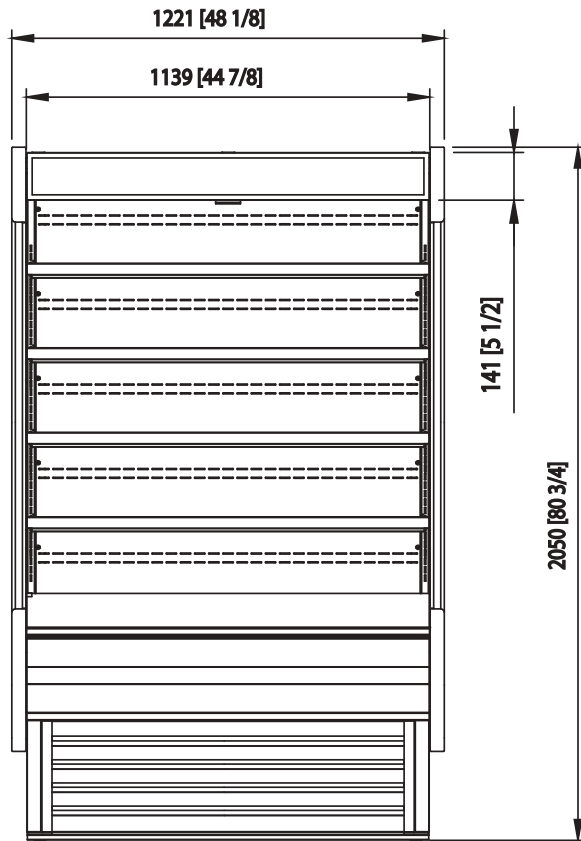

Side view

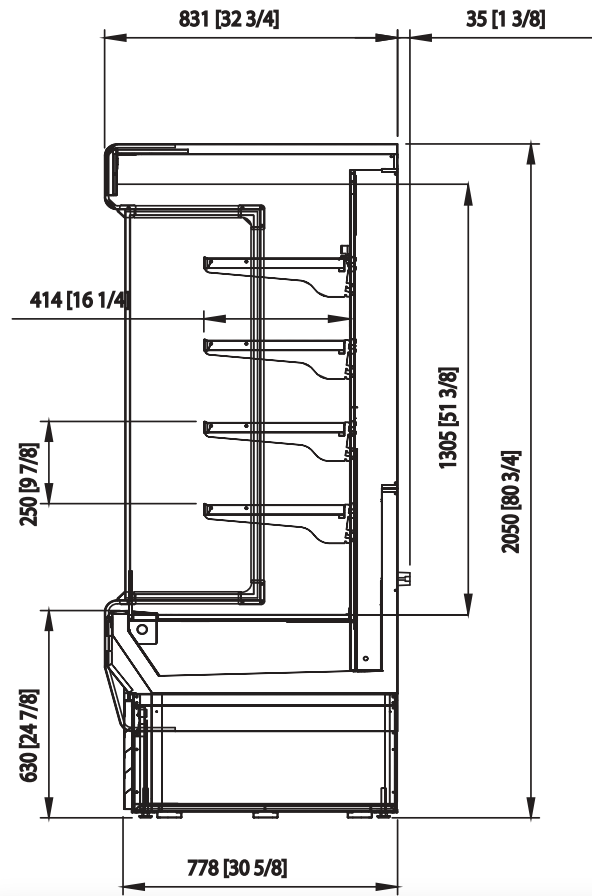

Top view

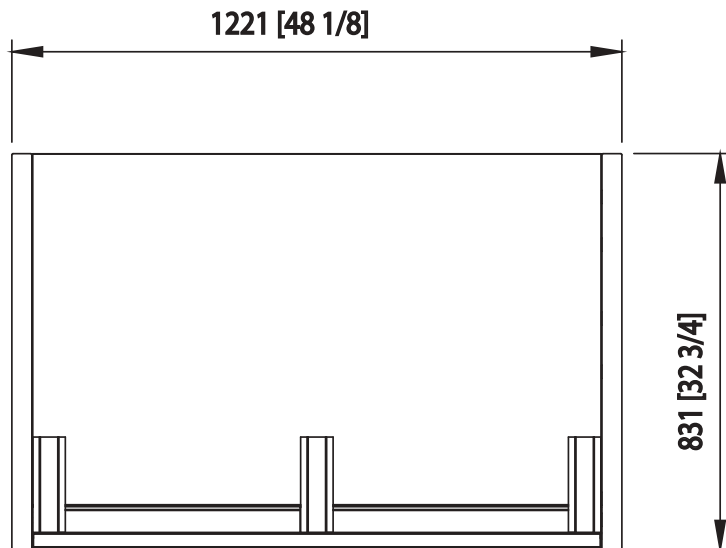

Capacity Cu.Ft.	26.8
Shelves	4
Refrigerant	R-404 A
Temperature Range	38°F ~ 44°F
Easy Maintenance	Sliding Condensing Unit
Connection	9.8 ft long (3m) flexible three wire cord with molded plug
Lighting	LED Interior lighting
HP	1
Voltage	115V/60Hz
Amps	16.5
NEMA Config.	NEMA 5-20



- This product may expose you to chemicals including Diisononyl Phthalate(DINP), which is known to the State of California to cause cancer. For more information go to www.P65Warnings.ca.gov.
 - Ce produit peut vous exposer à des agents chimiques incluant le Diisononyl Phthalate(DINP), reconnu par l'Etat de Californie comme causant le cancer, Pour de plus amples renseignements, consulter le site www.P65Warnings.ca.gov.



223 W. Rosecrans Ave., CA 90248
 T: 310-808-0102

9 W. Shelton Terrace #A, Hillside, NJ 07205
 T: 470-625-0182

7025 Amwiler industrial Drive, Suite A, Atlanta GA
 T: 908-688-0970