

PROJECT:	
MODEL #:	
ITEM #:	QTY:
AVAILABLE W/H:	APPROVAL:

Back Bar Coolers



BBB59-2B-HC



BBB69-3B-HC



BBB23-1B-HC



BBB90-4B-HC

STANDARD FEATURES

Cabinet construction

- Stainless steel top with black vinyl coated steel walled exterior. Interior is galvanized steel with stainless steel floor.
- High density foamed in place polyurethane insulation – Environmentally safe.
- Two (2) adjustable shelves per section
- Interior height allows stacking of three "tall boy" beers

Refrigeration

- Hydrocarbon refrigerants (R-290) – increases energy efficiency by up to 25% compared to using HFC refrigerants. It is safer for the environment and does not cause ozone depletion.

- Front breathing, side mounted compressor unit. Compressor configuration allows unit to be efficient in narrow spaces and be serviced without being moved.
- Epoxy coated evaporator reduces potential corrosion
- Innovative hot gas frame heating system reduces condensation and increases energy efficiency.
- Refrigerators have a temperature range between 33°F ~ 39°F
- Automatic defrosting

Doors

- Black recessed door handles
- Durable gasket with easy replacement.

- Standard door locks

Lighting

- Interior LED lighting

Standard

- NSF/ANSI Standard 7 compliant

Connection

- 9 ft long flexible three wire cord with molded plug

Optional Features & Accessories

- 6" legs available
- 4" caster standard on BBB23-1B-HC model

Back Bar Coolers

PRODUCT PLAN VIEW

- Top View -

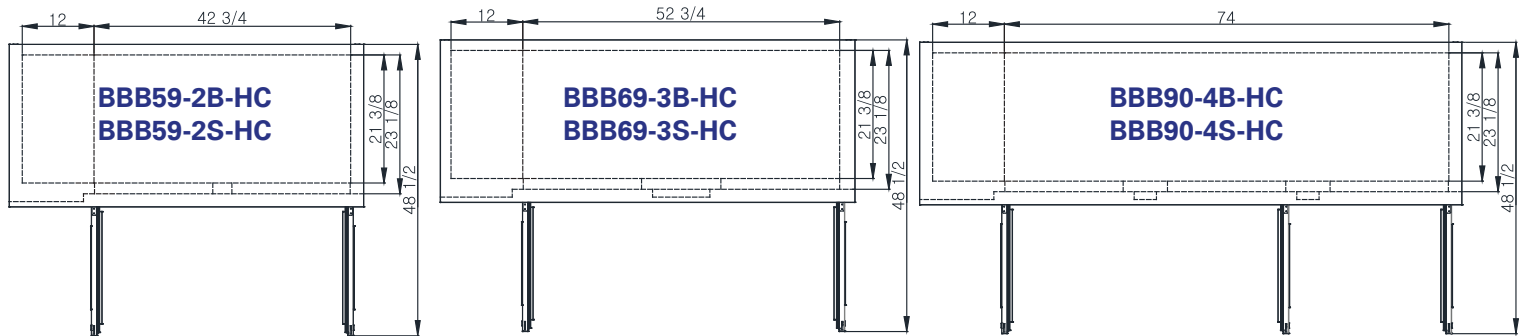

- Front View -

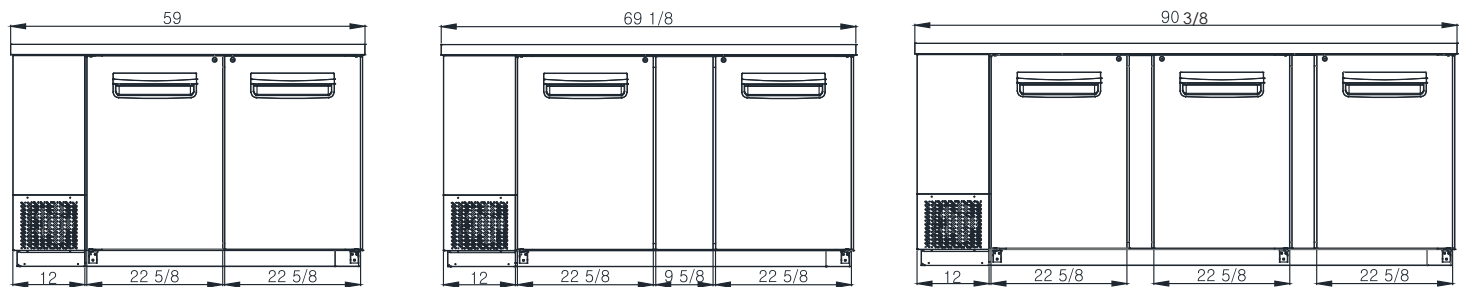

- Side View -

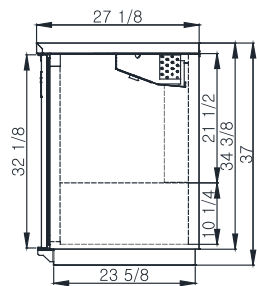

- Top View -

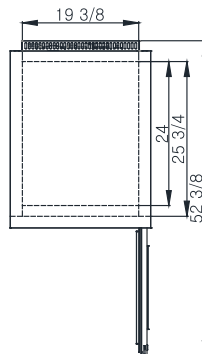

BBB23-1B-HC
BBB23-1S-HC

- Front View -

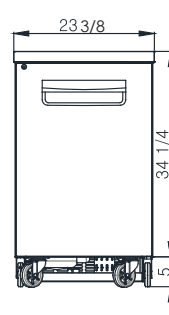

- Side View -

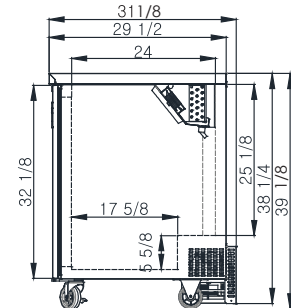

PRODUCT SPECIFICATION

Back Bar Coolers

Model	Product Description			Refrigerant	Temperature Range	Easy Maintenance			Cord Length (ft/m)			
	Back Bar Coolers			R-290	33°F ~ 39°F	Sliding Condensing Unit			9.8ft (3m)			
	Doors	Capacity (Cu.Ft.)	Shelves	Cabinet Dimensions (inches / mm)			HP	Voltage	Amps	NEMA config.	Weight (lbs / kg)	
			L	D	H						Net Weight	Ship Weight
BBB23-1B(S)-HC	1	7.9	2	23 3/8" (595mm)	31 1/8" (792mm)	39 1/8" (995mm)	1/4	115V / 60Hz	3.0	NEMA 5-15	128 (58)	134 (61)
BBB59-2B(S)-HC	2	19.4	4	59" (1500mm)	27 1/8" (688mm)	37" (940mm)	3/8	115V / 60Hz	3.5	NEMA 5-15	220 (100)	240 (109)
BBB69-3B(S)-HC	2	23.4	4	69 1/8" (1755mm)	27 1/8" (688mm)	37" (940mm)	3/8	115V / 60Hz	3.5	NEMA 5-15	251 (114)	276 (125)
BBB90-4B(S)-HC	3	31.6	6	90 3/8" (2295mm)	27 1/8" (688mm)	37" (940mm)	3/8	115V / 60Hz	3.5	NEMA 5-15	309 (140)	342 (155)

*BLUE AIR has the right to change specifications without further notice.