



BEVERAGE-AIR®

Project: _____	AIA#
Item: _____	
Location: _____	SIS#
Approved: _____	

RI REACH-IN REFRIGERATOR

RI18HC Glass Door Bottom Mount Refrigerator Hydrocarbon Series

MODEL:
RI18HC-G



3 Year Parts/Labor Warranty
Additional 4 Year Compressor Warranty

CABINET CONSTRUCTION

- Stainless steel exterior and interior
- Full electronic control
- Interior LED Light
- Four (4) shelves standard
- One piece grille
- Self-closing door with 120° Stay-open feature, on spring loaded hinges
- Snap-in magnetic door gasket
- 3" Heavy duty casters standard
- Maintains temperature between 36° and 38°F

OPTIONS & ACCESSORIES

- Epoxy shelves & clips
- 6" Casters or 6" leg optional
- Wire shelf dividers
- Right or left hinged door
- Remote option (see note on back page)

REFRIGERATION SYSTEM

- Refrigeration system uses R290 refrigerant to comply with all environmental concerns
- Automatic, non-electric defrost
- Epoxy coated evaporator coil

RI18HC BOTTOM MOUNT REACH-INS: RI SERIES MODELS



3779 Champion Blvd., Winston-Salem, NC 27105
1-888-845-9800 Fax: 1-336-245-6453
Beverage-Air.com Sales@bevair.com



BEVERAGE-AIR®

MODEL	R118HC-G
EXTERNAL DIMENSIONAL DATA	
Width Overall	27 1/4"
Depth Overall	29 1/8"
Height Overall	72 1/4"
Number of Doors	1
Depth with Door Open 90°	52 3/4"
Door Opening (in)	24 " X 52 3/4"
INTERNAL DIMENSIONAL DATA	
NET Capacity (cubic ft.)	16.85
Internal Width Overall (in)	24 1/4"
Internal Depth Overall (in)	21 1/4"
Internal Height Overall (in)	53"
Number of Shelves	4
ELECTRICAL DATA	
Full Load Amperes 115/60/1	5.5
REFRIGERATION DATA	
Horsepower	1/4
Capacity (BTU/HR)	1997
WEIGHT DATA	
Gross Weight - Crated	367 lbs
Height - Crated	76"
Width - Crated	30"
Depth - Crated	32"

Bottom Mount Reach-In Glass Door Model: R118HC-G

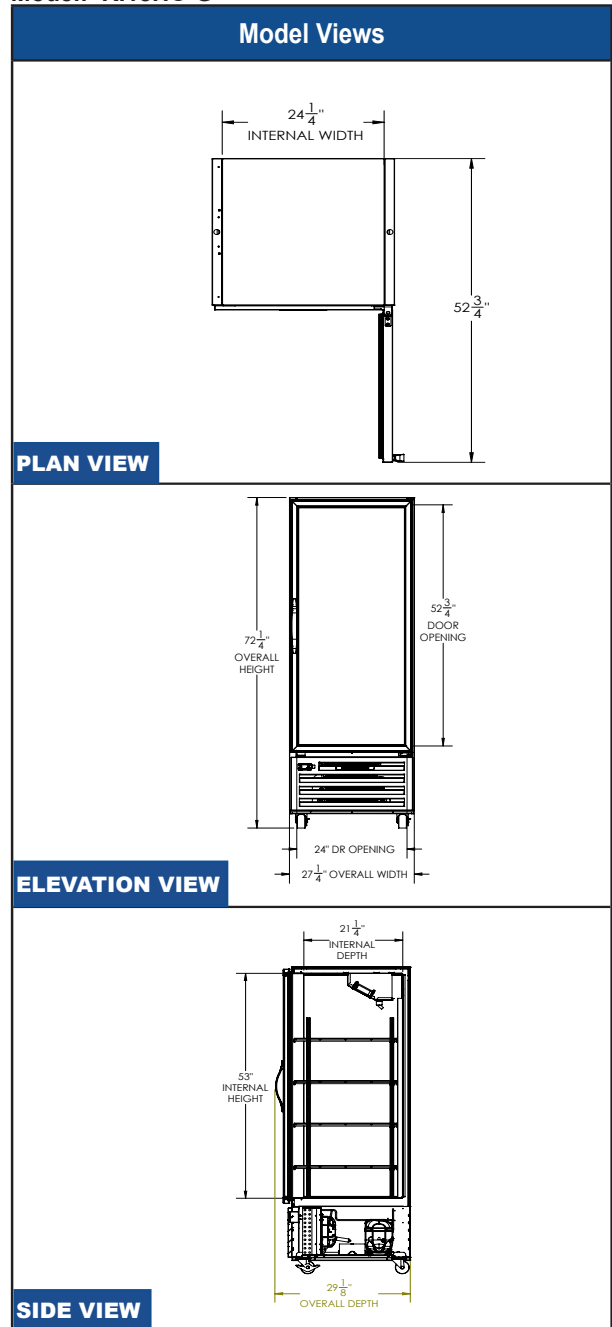

ELECTRICAL CONNECTION



115/60/1
NEMA-5-15P

Unit pre-wired at factory and include 8' long cord and plug set.



an Ali Group Company



The Spirit of Excellence

3779 Champion Blvd., Winston-Salem, NC 27105
 1-888-845-9800 Fax: 1-336-245-6453
 Beverage-Air.com Sals@bevalr.com