



Stainless design.
Stellar performance.
Superior value.

Project name: _____

Location: _____

Item #: _____ QTY: _____

Model #: _____

ABB72G

REFRIGERATOR

GLASS DOOR BACK BAR REFRIGERATOR



ABB72G

- ▶ Tested to NSF Standard 7 requirements for open food storage.
- ▶ Standard with two years parts and labor warranty and a five year compressor warranty.
- ▶ Arctic Air products must pass numerous quality control inspections throughout the manufacturing process.
- ▶ All products are pressurized with environmentally friendly and more efficient Hydrocarbon gas.



COMMERCIAL FREEZERS & REFRIGERATORS

Division of Broich Enterprises, Inc. 7550 Market Place Dr Eden Prairie, MN 55344
952-941-2270 Fax: 952-941-3066 www.arcticairco.com info@arcticairco.com



ABB72G

REFRIGERATOR

GLASS DOOR BACK BAR REFRIGERATOR



Top is 1.5" thick solid foamed stainless steel.

24" depth conserves important work space.

Standard with interior top ventilated s/s duct to allow for even temperature across all doors.

Front accessible condensing unit for easy cleaning and maintenance.

Self-contained capillary tube system using environmentally friendly R290 Hydrocarbon gas.

Electronic thermostat with digital LED display for accurate control located behind front access panel.

Bright stainless steel interior.

Interior LED lighting.

Exterior cabinet construction consists of black powder coated steel front and sides.

Easy to mount plate casters (two lockable) are standard with all units.

Each glass door is equipped with locks and magnetic gaskets that are removable for cleaning.

Optional larger 5.75" casters available (part #67000K, set of 4).

▶ Tested to NSF Standard 7 requirements for open food storage.

▶ Standard with full two year parts and labor warranties and a five year compressor warranty.

STAINLESS STEEL DESIGN • STELLAR PERFORMANCE • SUPERIOR VALUE

Model Number	External Dimensions			Doors	Temperature Range	12 oz Cans	Cubic Feet	Cord Length	HP	AMPS	REF	NEMA Plug	Crate Weight
	Width	Depth	Height**										
ABB72G	73.125"	24"	39.625"	3	33°F to 41°F	84 6-pk	20.7	8'	3/7	3	R290	5-15P	410Lbs

**Height includes 3.375" for casters

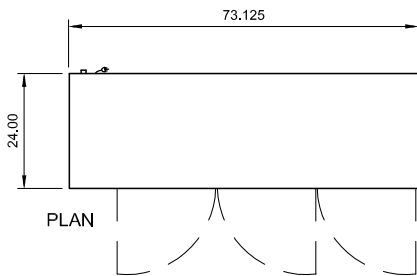

73.125

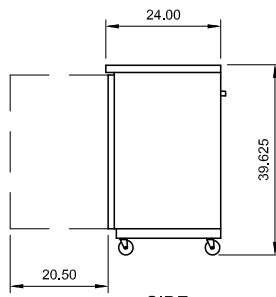

SIDE

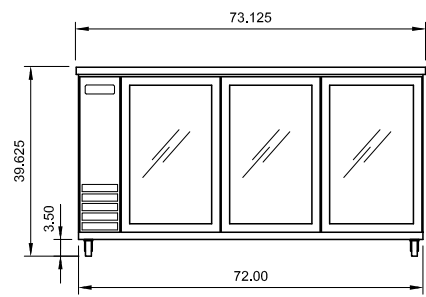

ELEVATION

